

NOTICE!!

These documents have been scanned!

Do not place un-scanned documents beneath this notice!

Do not remove this notice from this file!

GPO Jacket No. 560-102
Print Order 61540
Rise Business Services, LLC
Job=AZ15 5/2/2019



Box Number= AZ15019



Claim Begin-End: AMC437117-AMC437124

1 Initial Receipt



AZ15019-25

AMC436731-AMC437154

United States Department of the Interior
Bureau of Land Management
 LANDS/RECREATION & PLANNING
 ONE N CENTRAL AVE
 PHOENIX, AZ 85004 -2203
 Phone: 602-417-9200

Receipt

No: 3515187

Transaction #: 3616768	
Date of Transaction: 03/14/2016	
CUSTOMER:	
	GERALD GORDON PO BOX 800 CONGRESS, AZ 85332-0800 US

INTEREST
 BY: R. King

LINE #	QTY	DESCRIPTION	REMARKS	UNIT PRICE	TOTAL
1	8.00	LOCATABLE MINERALS / MINING CLAIMS-NEW, UNADJUD, ONE OR MORE AUTH NOS / NEW MINING CLAIMS LOCATION FEE CASES: AMC437117/\$37.00, AMC437118/\$37.00, AMC437119/\$37.00, AMC437120/\$37.00, AMC437121/\$37.00, AMC437122/\$37.00, AMC437123/\$37.00, AMC437124/\$37.00		- n/a -	296.00
2	8.00	LOCATABLE MINERALS / MINING CLAIMS-NEW, UNADJUD, ONE OR MORE AUTH NOS / NEW MINING CLAIM PROCESSING FEE CASES: AMC437117/\$20.00, AMC437118/\$20.00, AMC437119/\$20.00, AMC437120/\$20.00, AMC437121/\$20.00, AMC437122/\$20.00, AMC437123/\$20.00, AMC437124/\$20.00		- n/a -	160.00
3	8.00	LOCATABLE MINERALS / MINING CLAIMS-NEW, UNADJUD, ONE OR MORE AUTH NOS / NEW MINING CLAIMS MAINTENANCE FEE CASES: AMC437117/\$155.00, AMC437118/\$155.00, AMC437119/\$155.00, AMC437120/\$155.00, AMC437121/\$155.00, AMC437122/\$155.00, AMC437123/\$155.00, AMC437124/\$155.00		- n/a -	1240.00
TOTAL:					\$1,696.00

PAYMENT INFORMATION			
NOTE: Items will appear on credit card statement as "Bureau of Land Mgmt CO".			
1	AMOUNT:	1696.00	POSTMARKED: N/A
	TYPE:	CREDIT CARD	RECEIVED: 03/14/2016
	NAME:	GORDON, GERALD	

	PO BOX 800 CONGRESS AZ 85332-0800 US	
CARD NO:	XXXXXXXXXXXX4937	AUTH CODE: 210166
NAME ON CARD:	GERALD GORDON	
EXPIRES:	12/2019	
SIGNATURE:		

REMARKS

This receipt was generated by the automated BLM Collections and Billing System and is a paper representation of a portion of the official electronic record contained therein.

NOTICE!!

These documents have been scanned!

Do not place un-scanned documents beneath this notice!

Do not remove this notice from this file!

GPO Jacket No. 560-102
Print Order 61540
Rise Business Services, LLC
Job=AZ15 5/2/2019



Box Number= AZ15019



Claim Begin-End: AMC437117-AMC437124

2 Correspondence



AZ15019-25

AMC436731-AMC437154

SENDER: COMPLETE THIS SECTION

- Complete items 1, 2, and 3.
- Print your name and address on the reverse so that we can return the card to you.
- Attach this card to the back of the mailpiece, or on the front if space permits.

1. Article Addressed to:

CRAIG A MILDEN
 924 JEFFERSON ST
 MALVERN AR 72104-4638
 920/RE/AMC437117



9590 9402 1933 6123 0036 56

2. Article Number (Transfer from service label)

7014 2870 0000 1115 7479

COMPLETE THIS SECTION ON DELIVERY

A. Signature

X

 Agent Addressee

B. Received by (Printed Name)

Craig M. Milden

C. Date of Delivery

11/4/16

D. Is delivery address different from item 1? YesIf YES, enter delivery address below: No

3. Service Type

- Adult Signature
- Adult Signature Restricted Delivery
- Certified Mail®
- Certified Mail Restricted Delivery
- Collect on Delivery
- Collect on Delivery Restricted Delivery

- Priority Mail Express®
- Registered Mail™
- Registered Mail Restricted Delivery
- Return Receipt for Merchandise
- Signature Confirmation™
- Signature Confirmation Restricted Delivery

Restricted Delivery

(over \$500)

USPS TRACKING #



First-Class Mail
Postage & Fees Paid
USPS
Permit No. G-10

9590 9402 1933 6123 0036 56

**United States
Postal Service**

• Sender: Please print your name, address, and ZIP+4® in this box•

UNITED STATES
DEPARTMENT OF THE INTERIOR
Bureau of Land Management
Arizona State Office
One N. Central Avenue, Suite 800
Phoenix, AZ 85004-4427

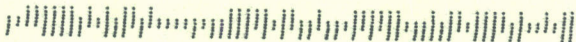



United States Department of the Interior



BUREAU OF LAND MANAGEMENT

Arizona State Office

One North Central Avenue, Suite 800

Phoenix, Arizona 85004-4427

www.blm.gov/az/

NOV 14 2016

In Reply Refer To:
3800 (9200) RE
AMC437117

CERTIFIED MAIL - RETURN RECEIPT REQUESTED No. 7014 2870 0000 1115 7479

DECISION

CRAIG A MILDEN : This decision affects those claims shown
924 JEFFERSON ST : in the block below.
MALVERN, AR 72104-4638 :

AMC437120
DIG IT

MINING CLAIMS DECLARED FORFEIT

The mining claims listed above have been declared forfeit as of September 1, 2016, for failure to timely file the required maintenance fee payment or small miner's maintenance fee waiver (waiver).

Claimants are required to pay an annual non-refundable maintenance fee of \$155 per 20 acres or portion thereof, or submit a waiver, on or before September 1 of each year. These requirements were established by 30 U.S.C. 28f-1, as amended, and 43 CFR 3834 and 3835.

Our records do not show receipt of a maintenance fee payment or small miner waiver filed on or before the due date. Therefore, the claims listed above are forfeit.

Reclamation Requirements

This decision does not relieve you of the liability for reclamation of all areas disturbed by your activities on lands covered by the subject mining claim(s) and/or site(s). After you complete the reclamation, you must notify the authorized officer of the appropriate surface managing agency so that the authorized officer may conduct a final site inspection and determine whether you may be released from liability. If you fail to reclaim the land to the satisfaction of the authorized officer, the surface management agency may cite you for noncompliance under its surface management regulations. For land administered by the Bureau of Land Management (BLM), if you fail to

reclaim the land to the satisfaction of the authorized officer as required in 43 CFR Subpart 3809, BLM will issue an order of noncompliance under 43 CFR 3809.601(a). If you fail to comply with the non-compliance order, BLM may take further action under 43 CFR 3809.604. Failure to conduct reclamation is a prohibited act that may subject you to criminal penalties. See 43 CFR 3809.605(h) and 43 CFR 3809.700.

Appeal Procedures

This decision may be appealed to the Interior Board of Land Appeals, Office of the Secretary, in accordance with the regulations contained in 43 CFR, Part 4, and the enclosed Form 1842-1. If an appeal is taken, your notice of appeal must be filed in this office (at the above address) within 30 days from receipt of this decision. The appellant has the burden of showing that the decision appealed from is in error.

If you wish to file a petition pursuant to regulation 43 CFR 4.21 (58 FR 4939, January 19, 1993) for a stay of the effectiveness of this decision during the time that your appeal is being reviewed by the Board, the petition for a stay must accompany your notice of appeal. A petition for a stay is required to show sufficient justification based on the standards listed below. Copies of the notice of appeal and petition for a stay **must** also be submitted to each party named in this decision and to the Interior Board of Land Appeals and to the appropriate Office of the Solicitor (see 43 CFR 4.413) at the same time the original documents are filed with this office. If you request a stay, you have the burden of proof to demonstrate that a stay should be granted.

Standards for Obtaining a Stay

Except as otherwise provided by law or other pertinent regulation, a petition for a stay of a decision pending appeal shall show sufficient justification based on the following standards:

- (1) The relative harm to the parties if the stay is granted or denied,
- (2) The likelihood of the appellant's success on the merits,
- (3) The likelihood of immediate and irreparable harm if the stay is not granted, and
- (4) Whether the public interest favors granting the stay.

Please include your AMC serial number(s) on all correspondence. If additional information is required, please call Rod Ebert at 602-417-9397.



Rebecca Heick
Deputy State Director
Lands, Minerals, and Energy Division

Enclosure

SENDER: COMPLETE THIS SECTION

- Complete items 1, 2, and 3.
- Print your name and address on the reverse so that we can return the card to you.
- Attach this card to the back of the mailpiece, or on the front if space permits.

1. Article Addressed to:

GERALD GORDON
 PO BOX 800
 CONGRESS AZ 85332-0800
 920/RM/AMC437117



9590 9402 2006 6123 3769 74

2. Article Number (Transfer from service label)

7015 1520 0002 6611 0601

COMPLETE THIS SECTION ON DELIVERY

A. Signature

X

 Agent Addressee

B. Received by (Printed Name)

Gerald Gordon

C. Date of Delivery

9/19/16

D. Is delivery address different from item 1? Yes

If YES, enter delivery address below: No

3. Service Type

- Adult Signature
- Adult Signature Restricted Delivery
- Certified Mail®
- Certified Mail Restricted Delivery
- Collect on Delivery
- Collect on Delivery Restricted Delivery
- Insured Mail

- Priority Mail Express®
- Registered Mail™
- Registered Mail Restricted Delivery
- Return Receipt for Merchandise
- Signature Confirmation™
- Signature Confirmation Restricted Delivery

Mail Restricted Delivery

USPS TRACKING#



First-Class Mail
Postage & Fees Paid
USPS
Permit No. G-10

9590 9402 2006 6123 3769 74

United States
Postal Service

• Sender: Please print your name, address, and ZIP+4® in this box •



UNITED STATES
DEPARTMENT OF THE INTERIOR
Bureau of Land Management
Arizona State Office
One N. Central Avenue, Suite 800
Phoenix, AZ 85004-4427

PHOENIX ARIZONA
RECEIVED
FIM AZ STATE OFFICE
SEP 26 09 00





United States Department of the Interior



BUREAU OF LAND MANAGEMENT

Arizona State Office

One North Central Avenue, Suite 800

Phoenix, Arizona 85004-4427

www.blm.gov/az/

SEP 07 2016

In Reply Refer To:

3800 (9200) RM

AMC437117

CERTIFIED MAIL - RETURN RECEIPT REQUESTED No. 7015 1520 0002 6611 0601

DECISION

GERALD GORDON : This decision affects those claims shown
PO BOX 800 : in the block below.
CONGRESS, AZ 85332-0800 :

AMC437119, AMC437121, AMC437122, AMC437123
CUINEZ, GOLD PATCH, GOLD PEAK, LUCKY LADY

ADDITIONAL INFORMATION REQUIRED

According to Bureau of Land Management (BLM) records, the land on which you located your mining claim was withdrawn under Secretarial Order dated March 27, 1943, for the Hassayampa Project. Document No. 14, Restoration to Mineral Location, Entry and Patent of Lands Withdrawn for Reclamation Purposes, dated November 12, 1954, opened the land, subject to stipulations, to Mineral Location, Entry, and Patent.

Therefore, in order to hold this mining claim you must agree to abide by the stipulations as set forth in the Order. Please read the enclosed Order and the stipulations. If you agree to abide by the stipulations, you **must** have your signature notarized on the enclosed Statement of Agreement and return it to the BLM within 30 days from the date you received this Decision. You must also file the signed and notarized Statement of Agreement with the county in which the claim is located. If we do not receive the signed and notarized Statement of Agreement within the 30 day timeframe your claim will be forfeited and void.



Please include your AMC serial number on all correspondence. If additional information is required, contact RéAnn Myers at 602-417-9413.

Amy F. Thawen
for Rebecca Heick
Deputy State Director
Lands, Minerals and Energy Division

Enclosures

NOTICE!!

These documents have been scanned!

Do not place un-scanned documents beneath this notice!

Do not remove this notice from this file!

GPO Jacket No. 560-102
Print Order 61540
Rise Business Services, LLC
Job=AZ15 5/2/2019



Box Number= AZ15019



Claim Begin-End: AMC437117-AMC437124

3 Transfers



AZ15019-25

AMC436731-AMC437154

Amc 437117

When recorded, mail to:

Name: Steven Williams

Address: P.O. Box 181

City/State/Zip Code: Congress, AZ, 85332

Space above this line for Recorder's use

QUITCLAIM DEED

KNOW ALL MEN BY THESE PRESENTS:

That I(we), William J Faulkner,
the undersigned, for the consideration of Ten Dollars (\$10.00), and other valuable considerations, do
hereby release, remise, and forever quitclaim unto Steven Williams

all right, title and interest in that certain Property situated in Yavapai County,
State of Arizona, and described as follows:

the unpatented federal mining claim AMC437117 BOULDER MOVE
as recording on doc 2016-0012161 in the Yavapai County Recorder Office.
Legal: S1/2 SW1/4 NW1/4 SEC. 27 T10N R5W, GSRB&M, AZ

ENTERED
AC 396
AUG 03 2017
PB

**NO TRANSFER NECESSARY
EXEMPT UNDER ARS 11-1134
A6**

IN WITNESS WHEREOF, I(we) have hereunto set my(our) hand(s) and seal this 10 day of
JULY, 2017.

WILLIAM J FAULKNER
Printed Name of Releasor

William J Faulkner
Signature of Releasor

Printed Name of Releasor

Signature of Releasor

Printed Name of Witness (if required by State Laws)

Signature of Witness (if required by State Laws)

2017 JUL 21 P 2:36
RECEIVED

ACKNOWLEDGMENT
(States Other Than California)

State of ^{UK} ~~Arizona~~ UTAH)
County of Grand) ss.

On this 10th day of July, 2017, before me, the undersigned
Notary Public, personally appeared William J Faulkner

known to me to be the individual(s) who executed the foregoing instrument and acknowledged the same
to be his(her)(their) free act and deed.

My Commission Expires: April 6th 2019

Lauren Kennedy
Notary Public

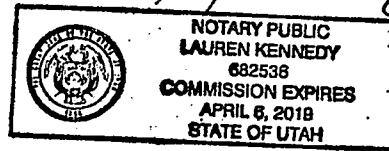

RECEIVED
2017 JUL 21 P 2:36
TUCSON, ARIZONA

TO: UNITED STATES DEPARTMENT OF THE INTERIOR
BUREAU OF LAND MANAGEMENT
ONE N. CENTRAL AVE SUITE 800
PHOENIX, AZ, 85004-4427

July 10th, 2017

NOTICE OF CHANGE IN OWNERSHIP OF MINING CLAIM

This letter and enclosed quitclaim deed, and check for the \$10. transfer fee, serves as notice that the:

AMC437117 Boulder Move

unpatented mining claim was transferred to the new owner:

Steven Williams
P.O. Box 181
Congress, AZ, 85332

New ID



by instrument of quitclaim deed.

Sincerely,

William J Faulkner

Enclosed:
Notification letter
Quitclaim deed
Transfer fee of \$10.

RECEIVED
JUL 21 2 36 PM '17
BUREAU OF LAND MANAGEMENT
PHOENIX, ARIZONA

steven Williams

P.O. Box 181

Congress, AZ, 85332

U.S. MAIL PERMIT NO. 100 PHOENIX, AZ

POSTAGE WILL BE PAID BY ADDRESSEE

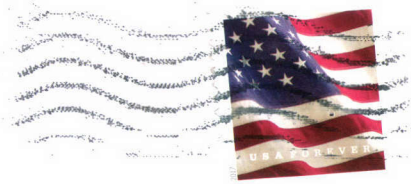

Dept of Interior

BLM

ONE N. Central AVE

Suite 800

Phoenix, AZ, 85004-4427

PHOENIX, ARIZONA

2017 JUL 21 P 2:36Z

RECEIVED
BLM AZ STATE OFFICE

85004-442700



United States Department of the Interior
Bureau of Land Management
 DIV OF LANDS, MINRLS & ENERGY
 ONE N CENTRAL AVE
 PHOENIX, AZ 85004 -4427
 Phone: 602-417-9200

Receipt

No: 3901839

Transaction #: 4011199	
Date of Transaction: 07/24/2017	
CUSTOMER:	
GERALD GORDON PO BOX 800 CONGRESS, AZ 85332-0800 US	

LINE #	QTY	DESCRIPTION	REMARKS	UNIT PRICE	TOTAL
1	1.00	LOCATABLE MINERALS / MINING CLAIMS- NOT NEW-UNADJUD, ONE AUTH NO. ONLY / MINING CLAIM MONEY RECEIVED CASES: AMC437117/\$10.00	TRF/1	- n/a -	10.00
TOTAL:					\$10.00

PAYMENT INFORMATION			
1	AMOUNT:	10.00	POSTMARKED: N/A
	TYPE:	CHECK	RECEIVED: 07/21/2017
	CHECK NO:	1157	
	NAME:	GORDON, GERALD PO BOX 800 CONGRESS AZ 85332-0800 US	

REMARKS

This receipt was generated by the automated BLM Collections and Billing System and is a paper representation of a portion of the official electronic record contained therein.

**DEPARTMENT OF THE INTERIOR
BUREAU OF LAND MANAGEMENT
MINING CLAIMS**

Run Date/Time: 08/03/2017 08:00 AM

(LIVE) Serial Register Page

Page 1 of 1

01 10-21-1976;090STAT0090;43USC1744
Case Type 384201: PLACER CLAIM
Claim Name: BOULDER MOVE
Commodity :
Case Disposition: ACTIVE
Required Maintenance Fee: \$155.00

Total Acres
20.000

Serial Number
AMC437117
Lead File Number
AMC437117

Name & Address	Int Rel
WILLIAMS STEVEN PO BOX 181 CONGRESS, AZ 85332-0181	CLAIMANT

Mer Twp Rng Sec	Quadrant	District/Field Office	County
14 0100N 0050W 027	NW	HASSAYAMPA FO	YAVAPAI

Act Date	Code	Action	Action Remarks	Receipt Number
03/10/2016	403	LOCATION DATE		
03/14/2016	395	RECORDATION NOTICE RECD	1	3515187
08/23/2016	782	MAINTENANCE FEE PAYMENT	2017;\$155	3638868
03/14/2016	484	LOCATION YEAR / MAINTENANCE	2016;\$155	3515187
07/21/2017	392	MONIES RECEIVED	\$10.00;1	3901839
07/21/2017	396	TRF OF INTEREST FILED	FAULKNER WILLIAM J	3901839
08/22/2016	396	TRF OF INTEREST FILED	GORDON GERALD	3638420
07/27/2016	669	LAND STATUS CHECKED		
03/14/2016	501	ACCT ADV IN LEAD FILE	AMC437117-AMC437124;	

Line Nr Remarks

MC Mass Owner Update

Starting Serial Number

437117

Ending Serial Number

437117

Available Options
Delete Owner - 396 TRF OF INT - (money sent to CBS) <input type="checkbox"/>

Owner Details

Owner	Address	Address2	City	State	Zip
FAULKNER WILLIAM J <input type="button" value="Lookup"/>	11265 W RUDDY DR		MARANA	AZ	856537726

Action Date: 07/21/2017

Action Remark: FAULKNER WILLIAM J

Receipt Nr: 3901839

Errors:

Transaction Successful.

New Customer Screen

System ID: MC
Proprietor Number: 2418941
Proprietor Name: WILLIAMS STEVEN
Category: P - PRIVATE
Address: PO BOX 181

City: CONGRESS
State: AZ
Zip: 853320181
Email:
Phone:



Customer details successfully Inserted for Customer Id 2418941

**DEPARTMENT OF THE INTERIOR
BUREAU OF LAND MANAGEMENT...
MINING CLAIMS**

(LIVE) Serial Register Page

Run Date/Time: 08/03/2017 07:49 AM

Page 1 of 1

01 10-21-1976;090STAT0090;43USC1744

Case Type 384201: PLACER CLAIM

Claim Name: BOULDER MOVE ✓

Commodity :

Case Disposition: ACTIVE

Required Maintenance Fee: \$155.00

Total Acres
20.000

Serial Number
AMC437117 ✓
Lead File Number
AMC437117

PRIOR TO TRANSFER

Name & Address

Int Rel

FAULKNER WILLIAM J ✓ 11265 W RUDDY DR MARANA, AZ 85653-7726 CLAIMANT

Mer Twp Rng Sec

Quadrant

District/Field Office

County

14 0100N 0050W 027 NW HASSAYAMPA FO YAVAPAI

Act Date	Code	Action	Action Remarks	Receipt Number
03/10/2016	403	LOCATION DATE		
03/14/2016	395	RECORDATION NOTICE RECD	1	3515187
08/23/2016	782	MAINTENANCE FEE PAYMENT	2017;\$155	3638868
03/14/2016	484	LOCATION YEAR / MAINTENANCE	2016;\$155	3515187
07/21/2017	392	MONIES RECEIVED	\$10.00;1	3901839
08/22/2016	396	TRF OF INTEREST FILED	GORDON GERALD	3638420
07/27/2016	669	LAND STATUS CHECKED		
03/14/2016	501	ACCT ADV IN LEAD FILE	AMC437117-AMC437124;	

Line Nr Remarks

437117

When recorded, mail to:

Name: SANDRA K WINRIGHT

Address: 318 E. JEFFERSON

City/State/Zip Code: GALLUP, NM, 87301

Space above this line for Recorder's use

QUITCLAIM DEED

KNOW ALL MEN BY THESE PRESENTS:

That I(we), GERALD GORDON,
the undersigned, for the consideration of Ten Dollars (\$10.00), and other valuable considerations, do
hereby release, remise, and forever quitclaim unto SANDRA K WINRIGHT

all right, title and interest in that certain Property situated in YAVAPAI County,
State of ARIZONA, and described as follows:

**the unpatented federal mining claim AMC437119 CUINAZ, as recorded in document
2016-0012162 in the Yavapai County Recorders Office.
S1/2NW1/4SW1/4 SEC.11 T8N R5W, GSRB&M, AZ.**

**NO TRANSFER NECESSARY
EXEMPT UNDER ARS 11-1134
A6**

IN WITNESS WHEREOF, I(we) have hereunto set my(our) hand(s) and seal this 21st day of
SEPTEMBER, 2016.

GERALD GORDON

Printed Name of Releasor



Signature of Releasor

Printed Name of Releasor

Signature of Releasor

Printed Name of Witness (if required by State Laws)

Signature of Witness (if required by State Laws)

RECEIVED
BLM AZ STATE OFFICE
2016 SEP 21 P 3:11
PHOENIX, ARIZONA

ACKNOWLEDGMENT
(States Other Than California)

State of INDIANA)
) ss.
County of NEWTON)

On this 21st day of SEPTEMBER, 2016, before me, the undersigned
Notary Public, personally appeared GERALD GORDON

known to me to be the individual(s) who executed the foregoing instrument and acknowledged the same
to be his(her)(their) free act and deed.

My Commission Expires: 01-10-21 Carol K. French
Notary Public

If acknowledged in the State of Florida, complete section(s) below

(Releasor) Personally Known (or) Produced Identification

If applicable, Type of Identification Produced: _____



CAROL K FRENCH
NOTARY PUBLIC - NEWTON COUNTY
MY COMMISSION EXPIRES JANUARY 10, 2021

(Co-Releasor) Personally Known (or) Produced Identification

If applicable, Type of Identification Produced: _____

RECEIVED
PLM AZ STATE OFFICE
2016 SEP 26 P 3:11
PHOENIX, ARIZONA

ACKNOWLEDGMENT
(State Of California)

State of California)
) ss.
County of _____)

On this _____ day of _____, _____, before me, _____
_____, the undersigned Notary Public, personally appeared,

personally known to me (or proved to me on the basis of satisfactory evidence) to be the person(s) whose
name(s) is(are) subscribed to the attached instrument and acknowledged to me that he(he)(they)
executed the same in his(her)(their) authorized capacity(ies), and that by his(her)(their) signature(s) on
the instrument; the person(s) or the entity upon behalf of which the person(s) acted, executed the
instrument.

WITNESS my hand and official seal.

Notary Public

TO: UNITED STATES DEPARTMENT OF THE INTERIOR
BUREAU OF LAND MANAGEMENT
ONE N. CENTRAL AVE SUITE 800
PHOENIX, AZ, 85004-4427

September 21, 2016

NOTICE OF CHANGE IN OWNERSHIP OF MINING CLAIM

This letter and enclosed quitclaim deed, and check for the \$10. transfer fee, serves as notice that the:

AMC 437119 CUINAZ

unpatented mining claim was transferred to the new owner:

SANDRA K WINRIGHT
318 E. JEFFERSON
GALLUP, NM, 87301

by instrument of quitclaim deed.

Sincerely,

Gerald Gordon

RECEIVED
BLM AZ STATE OFFICE
2016 SEP 26 P 3:11
PHOENIX, ARIZONA

Enclosed:
Notification letter
Quitclaim deed
Transfer fee of \$10.

GERALD GORDON
1984 W SR 10
Lake Village, IN, 46349

5 SUBURBAN IL 604

21 SEP 2016 PM 5 L



RECEIVED
BLM AZ STATE OFFICE

2016 SEP 26 P 3:11

PHOENIX, ARIZONA

Bureau of Land Management
ONE N. Central Ave. Suite 800
Phoenix, AZ, 85004-4427

85004-442700



United States Department of the Interior
Bureau of Land Management
 DIV OF LANDS, MINRLS & ENERGY
 ONE N CENTRAL AVE
 PHOENIX, AZ 85004 -4427
 Phone: 602-417-9200

Receipt

No: 3668104

Transaction #: 3772354	
Date of Transaction: 09/28/2016	
CUSTOMER:	
GERALD GORDON 1984 W STATE ROAD 10 LAKE VILLAGE,IN 46349-9341 US	

LINE #	QTY	DESCRIPTION	REMARKS	UNIT PRICE	TOTAL
1	1.00	LOCATABLE MINERALS / MINING CLAIMS- NOT NEW-UNADJUD, ONE AUTH NO. ONLY / MINING CLAIM MONEY RECEIVED CASES: AMC437119/\$10.00	TRF/1	- n/a -	10.00
TOTAL:					\$10.00

PAYMENT INFORMATION					
1	AMOUNT:	10.00	POSTMARKED:	09/21/2016	
	TYPE:	CHECK	RECEIVED:	09/26/2016	
	CHECK NO:	1612			
	NAME:	BROWN, TAHARA D 1984 W STATE ROAD 10 LAKE VILLAGE IN 46349-9341 US			

REMARKS

This receipt was generated by the automated BLM Collections and Billing System and is a paper representation of a portion of the official electronic record contained therein.

ENTERED
 SEP 29 2016
 BY: 

When recorded, mail to:

426212
437117

Name: KEVIN P CONTRERAS

Address: 4229 NORTH 19TH PLACE

City/State/Zip Code: PHOENIX, AZ, 85016

Space above this line for Recorder's use

QUITCLAIM DEED

KNOW ALL MEN BY THESE PRESENTS:

That I(we), GERALD GORDON,
the undersigned, for the consideration of Ten Dollars (\$10.00), and other valuable considerations, do
hereby release, remise, and forever quitclaim unto KEVIN P CONTRERAS

all right, title and interest in that certain Property situated in YAVAPAI County,
State of ARIZONA, and described as follows:

**THE UNPATENTED FEDERAL MINING CLAIM AMC437123 LUCKY LADY
AS RECORDED IN DOC.#2016-0012166 IN THE YAVAPAI COUNTY RECORDERS
OFFICE.
N1/2SW1/4SW1/4 SEC.11 T8N R5W, GSRB&M, AZ**

**NO TRANSFER NECESSARY
EXEMPT UNDER ARS 11-1134
A6**

IN WITNESS WHEREOF, I(we) have hereunto set my(our) hand(s) and seal this 9TH day of
SEPTEMBER 2016

GERALD GORDON

Printed Name of Releasor



Signature of Releasor

Printed Name of Releasor

Signature of Releasor

Printed Name of Witness (if required by State Laws)

Signature of Witness (if required by State Laws)

ACKNOWLEDGMENT
(States Other Than California)

State of INDIANA)

County of NEWTON)

SS.



DONNA K CORNING
NOTARY PUBLIC - NEWTON COUNTY
MY COMMISSION EXPIRES JULY 28 2024

On this 9TH day of SEPTEMBER, 2016, before me, the undersigned
Notary Public, personally appeared GERALD GORDON

known to me to be the individual(s) who executed the foregoing instrument and acknowledged the same
to be his(her)(their) free act and deed.

My Commission Expires: July 28, 2024 Donna K Corning
Notary Public

If acknowledged in the State of Florida, complete section(s) below:

(Releasor) Personally Known (or) Produced Identification

If applicable, Type of Identification Produced: _____

(Co-Releasor) Personally Known (or) Produced Identification

If applicable, Type of Identification Produced: _____

ACKNOWLEDGMENT
(State Of California)

State of California)

County of _____)

SS.

On this _____ day of _____, _____, before me, _____
_____, the undersigned Notary Public, personally appeared,

personally known to me (or proved to me on the basis of satisfactory evidence) to be the person(s) whose
name(s) is(are) subscribed to the attached instrument and acknowledged to me that he(he)(she)(they)
executed the same in his(her)(their) authorized capacity(ies), and that by his(her)(their) signature(s) on
the instrument; the person(s) or the entity upon behalf of which the person(s) acted, executed the
instrument.

WITNESS my hand and official seal.

Notary Public

TO: UNITED STATES DEPARTMENT OF THE INTERIOR
BUREAU OF LAND MANAGEMENT
ONE N. CENTRAL AVE SUITE 800
PHOENIX, AZ, 85004-4427

RECEIVED
BLM AZ STATE OFFICE

2016 SEP 22 P 2:54

PHOENIX, ARIZONA

SEPTEMBER 9TH, 2016

NOTICE OF CHANGE IN OWNERSHIP OF MINING CLAIM

This letter and enclosed quitclaim deed, and check for the \$10. transfer fee, serves as notice that the:

AMC 437123 LUCKY LADY

unpatented mining claim was transferred to the new owner:

KEVIN P CONTRERAS
4229 NORTH 19TH PLACE
PHOENIX, AZ, 85016

by instrument of quitclaim deed.

Sincerely,



Gerald Gordon

Enclosed:
Notification letter
Quitclaim deed
Transfer fee of \$10.

When recorded, mail to:

Name: John Tryon & Charlotte A Tryon

Address: 19310 North Ave 72 East

City/State/Zip Code: Dateland, AZ, 85333

RECEIVED
BLM AZ STATE OFFICE

2016 SEP 22 P 2:54

PHOENIX, ARIZONA

Space above this line for Recorder's use

QUITCLAIM DEED

KNOW ALL MEN BY THESE PRESENTS:

That I (we), GERALD GORDON & TAHARA BROWN,
the undersigned, for the consideration of Ten Dollars (\$10.00), and other valuable considerations, do
hereby release, remise, and forever quitclaim unto John Tryon & Charlotte A Tryon

all right, title and interest in that certain Property situated in Yavapai County,
State of Arizona, and described as follows:

**THE UNPATENTED FEDERAL MINING CLAIM AMC426213 ANTELOPE BEND AS
RECORDED IN DOC#2014-0005359 IN THE YAVAPAI COUNTY RECORDERS OFFICE
LOCATED IN NW1/4NW1/4 SEC.12 T9N R5W, GSRB&M, AZ**

**NO TRANSFER NECESSARY
EXEMPT UNDER ARS 11-1134
A6**

IN WITNESS WHEREOF, I (we) have hereunto set my (our) hand (s) and seal this 31st day of
August, 2016.

GERALD GORDON

Printed Name of Releasor

TAHARA BROWN

Printed Name of Releasor



Signature of Releasor

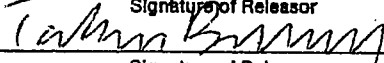

Signature of Releasor

Printed Name of Witness (if required by State Laws)

Signature of Witness (if required by State Laws)

ACKNOWLEDGMENT
(States Other Than California)

State of INDIANA)
County of Newton)

ss.

RECEIVED
BLM AZ STATE OFFICE

2016 SEP 22 P 2: 53

On this 31st day of August, 2016, before me, the undersigned
Notary Public, personally appeared GERALD GORDON & TAHARA BROWN

known to me to be the individual(s) who executed the foregoing instrument and acknowledged the same
to be his(her)(their) free act and deed.

My Commission Expires: 10/17/2018

Susan V. Wojtas
Notary Public

If acknowledged in the State of Florida, complete section(s) below:

(Releasor) Personally Known (or) Produced Identification

If applicable, Type of Identification Produced: _____



SUSAN V. WOJTAS
NOTARY PUBLIC - NEWTON COUNTY
MY COMMISSION EXPIRES OCTOBER 17, 2018

(Co-Releasor) Personally Known (or) Produced Identification

If applicable, Type of Identification Produced: _____

ACKNOWLEDGMENT
(State Of California)

State of California)
County of _____)

ss.

On this _____ day of _____, _____, before me, _____

_____, the undersigned Notary Public, personally appeared,

personally known to me (or proved to me on the basis of satisfactory evidence) to be the person(s) whose
name(s) is(are) subscribed to the attached instrument and acknowledged to me that he(he)(she)(they)
executed the same in his(her)(their) authorized capacity(ies), and that by his(her)(their) signature(s) on
the instrument; the person(s) or the entity upon behalf of which the person(s) acted, executed the
instrument.

WITNESS my hand and official seal.

Notary Public

TO: UNITED STATES DEPARTMENT OF THE INTERIOR
BUREAU OF LAND MANAGEMENT
ONE N. CENTRAL AVE SUITE 800
PHOENIX, AZ, 85004-4427

RECEIVED
BLM AZ STATE OFFICE
2016 SEP 22 P 2: 54
PHOENIX, ARIZONA

AUGUST 31ST, 2016

NOTICE OF CHANGE IN OWNERSHIP OF MINING CLAIM

This letter and enclosed quitclaim deed, and check for the \$20. transfer fee, serves as notice that the:

AMC 426213 ANTELOPE BEND

unpatented mining claim was transferred to the new owner:

JOHN TRYON AND CHARLOTTE A TRYON
19310 NORTH AVE 72 EAST
DATELAND, AZ, 85333

by instrument of quitclaim deed.

Sincerely,

Gerald Gordon & Tahara Brown

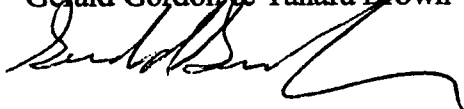

Enclosed:
Notification letter
Quitclaim deed
Transfer fee of \$20.

GERALD GORDON
1984 W SR 10
Lake Village, IN, 46349

U.S. MAIL PERMIT NO. 100 PHOENIX, ARIZONA



Bureau of Land Management
ONE N. Central Ave. Suite 800
Phoenix, AZ, 85004-4427

RECEIVED
BLM AZ STATE OFFICE
2011 SEP 22 P 2:53
PHOENIX, ARIZONA

85004-442700



**United States Department of the Interior
Bureau of Land Management
DIV OF LANDS, MINRLS & ENERGY
ONE N CENTRAL AVE
PHOENIX, AZ 85004 -4427
Phone: 602-417-9200**

Receipt

No: 3665114

Transaction #: 3769320	
Date of Transaction: 09/23/2016	
CUSTOMER:	
TAHARA D BROWN 1984 W STATE ROAD 10 LAKE VILLAGE, IN 46349-9341 US	

LINE #	QTY	DESCRIPTION	REMARKS	UNIT PRICE	TOTAL
1	1.00	LOCATABLE MINERALS / MINING CLAIMS- NOT NEW-UNADJUD, ONE AUTH NO. ONLY / MINING CLAIM MONEY RECEIVED CASES: AMC437123/\$30.00	TRF/3	- n/a -	30.00
TOTAL:					\$30.00

PAYMENT INFORMATION					
1	AMOUNT:	30.00	POSTMARKED:	09/19/2016	
	TYPE:	CHECK	RECEIVED:	09/22/2016	
	CHECK NO:	1608			
	NAME:	BROWN, TAHARA D 1984 W STATE ROAD 10 LAKE VILLAGE IN 46349-9341 US			

REMARKS

This receipt was generated by the automated BLM Collections and Billing System and is a paper representation of a portion of the official electronic record contained therein.

ENTERED
SEP 28 2016
BY: *[Signature]*

TO: UNITED STATES DEPARTMENT OF THE INTERIOR
BUREAU OF LAND MANAGEMENT
ONE N. CENTRAL AVE SUITE 800
PHOENIX, AZ, 85004-4427

437117
RECEIVED
BLM AZ STATE OFFICE
2016 AUG 22 P 2: 36
PHOENIX, ARIZONA

August 18th, 2016

NOTICE OF CHANGE IN OWNERSHIP OF MINING CLAIM

This letter and enclosed quitclaim deed, and check for the \$10. transfer fee, serves as notice that the:

AMC 437117 Boulder Move

unpatented mining claim was transferred to the new owner:

William J Faulkner
11265 Ruddy Dr.
Marana, AZ, 85653-7726

by instrument of quitclaim deed.

Sincerely,

Gerald Gordon



Enclosed:
Notification letter
Quitclaim deed
Transfer fee of \$10.

When recorded, mail to:

Name: WILLIAM J FAULKNER

Address: 11265 W. Ruddy Dr.

City/State/Zip Code: Marana, AZ, 85653-7726

Space above this line for Recorder's use

QUITCLAIM DEED

KNOW ALL MEN BY THESE PRESENTS:

That I (we), Gerald Gordon,
the undersigned, for the consideration of Ten Dollars (\$10.00), and other valuable considerations, do
hereby release, remise, and forever quitclaim unto WILLIAM J FAULKNER

all right, title and interest in that certain Property situated in Yavapai County,
State of Arizona, and described as follows:

**the unpatented Federal Mining Claim AMC437117 Boulder Move
located S1/2 SW1/4 NW1/4 SEC.27 T10N R5W, GSRB&M, AZ.
As recorded in doc # 2016-0012161 in the Yavapai County Recorders Office**

RECEIVED
BLM AZ STATE OFFICE
2016 AUG 22 P 2:45
PHOENIX, ARIZONA

**NO TRANSFER NECESSARY
EXEMPT UNDER ARS 11-1134
A6**

IN WITNESS WHEREOF, I (we) have hereunto set my (our) hand(s) and seal this 18TH day of
August, 2016.

GERALD GORDON

Printed Name of Releasor



Signature of Releasor

Printed Name of Releasor

Signature of Releasor

Printed Name of Witness (if required by State Laws)

Signature of Witness (if required by State Laws)

ACKNOWLEDGMENT
(States Other Than California)

State of Indiana)
County of Newton) ss.

On this 18TH day of AUGUST, 2016, before me, the undersigned Notary Public, personally appeared GERALD GORDON

known to me to be the individual(s) who executed the foregoing instrument and acknowledged the same to be his(her)(their) free act and deed.

My Commission Expires: 01-10-21

Carol K. French
Notary Public

If acknowledged in the State of Florida, complete section(s) below:

(Releasor) Personally Known (or) Produced Identification

If applicable, Type of Identification Produced: _____



CAROL K FRENCH
NOTARY PUBLIC - NEWTON COUNTY
MY COMMISSION EXPIRES JANUARY 10, 2021

(Co-Releasor) Personally Known (or) Produced Identification

If applicable, Type of Identification Produced: _____

ACKNOWLEDGMENT
(State Of California)

State of California)
County of _____) ss.

On this _____ day of _____, _____, before me, _____, the undersigned Notary Public, personally appeared,

RECEIVED
BLM AZ STATE OFFICE
2016 AUG 22 P 2:36
PHOENIX, ARIZONA

personally known to me (or proved to me on the basis of satisfactory evidence) to be the person(s) whose name(s) is(are) subscribed to the attached instrument and acknowledged to me that he(she)(they) executed the same in his(her)(their) authorized capacity(ies), and that by his(her)(their) signature(s) on the instrument, the person(s) or the entity upon behalf of which the person(s) acted, executed the instrument.

WITNESS my hand and official seal.

Notary Public

TO: UNITED STATES DEPARTMENT OF THE INTERIOR
BUREAU OF LAND MANAGEMENT
ONE N. CENTRAL AVE SUITE 800
PHOENIX, AZ, 85004-4427

August 18th, 2016

NOTICE OF CHANGE IN OWNERSHIP OF MINING CLAIM

This letter and enclosed quitclaim deed, and check for the \$10. transfer fee, serves as notice that the:

AMC 437122 Gold Peak

unpatented mining claim was transferred to the new owner:

Wesley G. Day
13128 N. Ash Dr.
Dolan Springs, AZ, 86441

by instrument of quitclaim deed.

Sincerely,

Gerald Gordon



Enclosed:
Notification letter
Quitclaim deed
Transfer fee of \$10.

RECEIVED
BLM AZ STATE OFFICE
2016 AUG 22 P 2:36
PHOENIX, ARIZONA

When recorded, mail to:

Name: WESLEY G. DAY

Address: 13128 N. ASH DR.

City/State/Zip Code: DOLAN SPRINGS, AZ, 86441

Space above this line for Recorder's use

QUITCLAIM DEED

KNOW ALL MEN BY THESE PRESENTS:

That I(we), GERALD GORDON,
the undersigned, for the consideration of Ten Dollars (\$10.00), and other valuable considerations, do
hereby release, remise, and forever quitclaim unto WESLEY G. DAY

all right, title and interest in that certain Property situated in YAVAPAI County,
State of ARIZONA, and described as follows:

**the unpatented federal mining claim AMC437122 GOLD PEAK
LOCATED IN THE N1/2NW1/4SW1/4 SEC.11 T8N R5W, GSRB&M, AZ
AS RECORDED IN DOCUMENT 2016-0012165 IN THE YAVAPAI COUNTY
RECORDERS OFFICE**

RECEIVED
BLM AZ STATE OFFICE
2016 AUG 22 P 2:34
PHOENIX, ARIZONA

**NO TRANSFER NECESSARY
EXEMPT UNDER ARS 11-1134
A6**

IN WITNESS WHEREOF, I(we) have hereunto set my(our) hand(s) and seal this 18TH day of
AUGUST, 2016

GERALD GORDON

Printed Name of Releasor

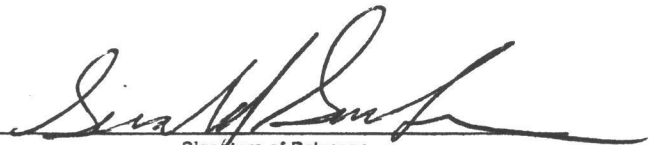

Signature of Releasor

Printed Name of Releasor

Signature of Releasor

Printed Name of Witness (if required by State Laws)

Signature of Witness (if required by State Laws)

ACKNOWLEDGMENT
(States Other Than California)

State of Indiana)
County of Newton) ss.

On this 18TH day of AUGUST, 2016, before me, the undersigned Notary Public, personally appeared GERALD GORDON

known to me to be the individual(s) who executed the foregoing instrument and acknowledged the same to be his(her)(their) free act and deed.

My Commission Expires: 01-10-21

Carol K. French
Notary Public

If acknowledged in the State of Florida, complete section(s) below:

(Releasor) Personally Known (or) Produced Identification

If applicable, Type of Identification Produced: _____



CAROL K. FRENCH
NOTARY PUBLIC - NEWTON COUNTY
MY COMMISSION EXPIRES JANUARY 10, 2021

(Co-Releasor) Personally Known (or) Produced Identification

If applicable, Type of Identification Produced: _____

ACKNOWLEDGMENT
(State Of California)

State of California)
County of _____) ss.

On this _____ day of _____, _____, before me, _____, the undersigned Notary Public, personally appeared, _____

PHOENIX, ARIZONA

2016 AUG 22 P 2:36

RECEIVED
BLM AZ STATE OFFICE

personally known to me (or proved to me on the basis of satisfactory evidence) to be the person(s) whose name(s) is(are) subscribed to the attached instrument and acknowledged to me that he(she)(they) executed the same in his(her)(their) authorized capacity(ies), and that by his(her)(their) signature(s) on the instrument; the person(s) or the entity upon behalf of which the person(s) acted, executed the instrument.

WITNESS my hand and official seal.

Notary Public

TO: UNITED STATES DEPARTMENT OF THE INTERIOR
BUREAU OF LAND MANAGEMENT
ONE N. CENTRAL AVE SUITE 800
PHOENIX, AZ, 85004-4427

RECEIVED
BLM AZ STATE OFFICE

2016 AUG 22 P 2:37

2016 AUG 22 P 2:37
PHOENIX, ARIZONA

August 18th, 2016

NOTICE OF CHANGE IN OWNERSHIP OF MINING CLAIM

This letter and enclosed quitclaim deed, and check for the \$10. transfer fee, serves as notice that the:

AMC 437124 Yellow Rock

unpatented mining claim was transferred to the new owner:

Michael R. Bachynski
7808 W. Paltaire Ave.
Glendale, AZ, 85303

by instrument of quitclaim deed.

Sincerely,

Gerald Gordon

Enclosed:
Notification letter
Quitclaim deed
Transfer fee of \$10.

When recorded, mail to:

Name: MICHAEL R. BACHYNSKI

Address: 7808 W. PALMAIRE AVE.

City/State/Zip Code: GLENDAL, AZ, 85303

Space above this line for Recorder's use

QUITCLAIM DEED

KNOW ALL MEN BY THESE PRESENTS:

That I (we), GERALD GORDON,
the undersigned, for the consideration of Ten Dollars (\$10.00), and other valuable considerations, do
hereby release, remise, and forever quitclaim unto MICHAEL R. BACHYNSKI

all right, title and interest in that certain Property situated in YAVAPAI County,
State of ARIZONA, and described as follows:

**the unpatented federal mining claim AMC437124 YELLOW ROCK
Located in N1/2NW1/4NE1/4 SEC.15 T8NR5W, GSRB&M, AZ
AS RECORDED IN DOC# 2016-0012167 OF THE YAVAPAI COUNTY
RECORDERS OFFICE**

RECEIVED
BLM AZ STATE OFFICE
2016 AUG 22 P 2:00
PHOENIX, ARIZONA

**NO TRANSFER NECESSARY
EXEMPT UNDER ARS 11-1134
A6**

IN WITNESS WHEREOF, I (we) have hereunto set my (our) hand(s) and seal this 18TH day of
AUGUST, 2016.

GERALD GORDON

Printed Name of Releasor



Signature of Releasor

Printed Name of Releasor

Signature of Releasor

Printed Name of Witness (if required by State Laws)

Signature of Witness (if required by State Laws)

ACKNOWLEDGMENT
(States Other Than California)

RECEIVED
BLM AZ STATE OFFICE
2016 AUG 22 P 2:37

State of Indiana)
County of Newton) ss.

PHOENIX, ARIZONA

On this 18TH day of AUGUST, 2016, before me, the undersigned
Notary Public, personally appeared GERALD GORDON

known to me to be the individual(s) who executed the foregoing instrument and acknowledged the same
to be his(her)(their) free act and deed.

My Commission Expires: 01-10-21 Carol K. French
Notary Public

If acknowledged in the State of Florida, complete section(s) below:

(Releasor) Personally Known (or) Produced Identification

If applicable, Type of Identification Produced: _____



CAROL K FRENCH
NOTARY PUBLIC - NEWTON COUNTY
MY COMMISSION EXPIRES JANUARY 10, 2021

(Co-Releasor) Personally Known (or) Produced Identification

If applicable, Type of Identification Produced: _____

ACKNOWLEDGMENT
(State Of California)

State of California)
County of _____) ss.

On this _____ day of _____, _____, before me, _____
_____, the undersigned Notary Public, personally appeared,

personally known to me (or proved to me on the basis of satisfactory evidence) to be the person(s) whose
name(s) is(are) subscribed to the attached instrument and acknowledged to me that he(he)(they)
executed the same in his(her)(their) authorized capacity(ies), and that by his(her)(their) signature(s) on
the instrument; the person(s) or the entity upon behalf of which the person(s) acted, executed the
instrument.

WITNESS my hand and official seal.

Notary Public

United States Department of the Interior
Bureau of Land Management
 DIV OF LANDS, MINRLS & ENERGY
 ONE N CENTRAL AVE
 PHOENIX, AZ 85004 -4427
 Phone: 602-417-9200

Receipt

No: 3638420

Transaction #: 3742323	
Date of Transaction: 08/23/2016	
CUSTOMER:	
GERALD GORDON 1984 W STATE ROAD 10 LAKE VILLAGE,IN 46349-9341 US	

LINE #	QTY	DESCRIPTION	REMARKS	UNIT PRICE	TOTAL
1	1.00	LOCATABLE MINERALS / MINING CLAIMS- NOT NEW-UNADJUD,ONE AUTH NO. ONLY / MINING CLAIM MONEY RECEIVED CASES: AMC437117/\$30.00	QCD - 3	- n/a -	30.00
TOTAL:					\$30.00

PAYMENT INFORMATION					
1	AMOUNT:	30.00	POSTMARKED:	08/19/2016	
	TYPE:	CHECK	RECEIVED:	08/22/2016	
	CHECK NO:	1605			
	NAME:	BROWN, TAHARA D 1984 W STATE ROAD 10 LAKE VILLAGE IN 46349-9341 US			

REMARKS

This receipt was generated by the automated BLM Collections and Billing System and is a paper representation of a portion of the official electronic record contained therein.

ENTERED
AUG 24 2016
 BY: 

Gerald Gordon
1984 W. State Rd 10
Lake Village, IN, 46349



1000



85004

U.S. POSTAGE
PAID
ROSELAWN, IN
46372
AUG 19, 16
AMOUNT
\$1.15
R2305K137255-04

RECEIVED
BLM AZ STATE OFFICE

2016 AUG 22 P 2:36

PHOENIX, ARIZONA

BLM - Dept. of Interior
One N. Central Ave
Suite 800
Phoenix, AZ, 85004-4427



TO: UNITED STATES DEPARTMENT OF THE INTERIOR
BUREAU OF LAND MANAGEMENT
ONE N. CENTRAL AVE SUITE 800
PHOENIX, AZ, 85004-4427

437117

July 5th, 2016

NOTICE OF CHANGE IN OWNERSHIP OF MINING CLAIM

This letter and enclosed quitclaim deed, and check for the \$10. transfer fee each, serves as notice that the:

AMC 437121 GOLD PATCH
AMC 437118 BURIED TREASURE

unpatented mining claim(s) were transferred to the new owner:

KENNETH G. WAGNER
8460 W. REDROCK
KIRKLAND, AZ, 86332

by instrument of quitclaim deed.

Sincerely,

GERALD GORDON



Enclosed:
Notification letter
Quitclaim deed
Transfer fee of \$10.
20.

RECEIVED
BLM AZ STATE OFFICE
2016 JUL 11 P 1:51
PHOENIX, ARIZONA

When recorded, mail to:

Name: KENNETH G. WAGNER

Address: 8460 W. Redrock

City/State/Zip Code: Kirkland, AZ, 86332

Space above this line for Recorder's use

QUITCLAIM DEED

KNOW ALL MEN BY THESE PRESENTS:

That I(we), GERALD GORDON,
the undersigned, for the consideration of Ten Dollars (\$10.00), and other valuable considerations, do
hereby release, remise, and forever quitclaim unto KENNETH G. WAGNER, 8460 Redrock, Kirkland, AZ, 86332

all right, title and interest in that certain Property situated in YAVAPAI County,
State of ARIZONA, and described as follows:

**THE UNPATENTED FEDERAL MINING CLAIM AMC437121 GOLD PATCH AS RECORDED IN DOCUMENT 2016-0012164
OF THE YAVAPAI COUNTY RECORDERS OFFICE.**

LOCATED IN THE S1/2SW1/4SW1/4 SEC. 11 T8N R5W, GSRB&M, AZ

**THE UNPATENTED FEDERAL MINING CLAIM AMC437118 BURIED TREASURE AS RECORDED IN DOCUMENT 2016-0010472
OF THE YAVAPAI COUNTY RECORDERS OFFICE.**

LOCATED IN THE E1/2NW1/4SW1/4 SEC. 27 T10N R5W, GSRB&M, AZ

PHOENIX, ARIZONA
16 JUL 11
RECORDED
EXEMPT UNDER ARS 11-1134
A6
57

IN WITNESS WHEREOF, I(we) have hereunto set my(our) hand(s) and seal this 24th day of
June, 2016

GERALD GORDON
Printed Name of Releasor

Signature of Releasor

Printed Name of Releasor

Signature of Releasor

Printed Name of Witness (if required by State Laws)

Signature of Witness (if required by State Laws)

ACKNOWLEDGMENT
(States Other Than California)

State of INDIANA)

County of Newton)

ss.

On this 24TH day of JUNE, 2016, before me, the undersigned

Notary Public, personally appeared GERALD GORDON

known to me to be the individual(s) who executed the foregoing instrument and acknowledged the same to be his(her)(their) free act and deed.

My Commission Expires: 10/17/2018

Susan V. Wojtas
Notary Public

If acknowledged in the State of Florida, complete section(s) below:

(Releasor) Personally Known (or) Produced Identification

If applicable, Type of Identification Produced: _____



SUSAN V. WOJTAS
NOTARY PUBLIC - NEWTON COUNTY
MY COMMISSION EXPIRES OCTOBER 17, 2018

(Co-Releasor) Personally Known (or) Produced Identification

If applicable, Type of Identification Produced: _____

ACKNOWLEDGMENT
(State Of California)

State of California)

County of _____)

ss.

On this _____ day of _____, _____, before me, _____

_____, the undersigned Notary Public, personally appeared,

personally known to me (or proved to me on the basis of satisfactory evidence) to be the person(s) whose name(s) is(are) subscribed to the attached instrument and acknowledged to me that he(he)(they) executed the same in his(her)(their) authorized capacity(ies), and that by his(her)(their) signature(s) on the instrument; the person(s) or the entity upon behalf of which the person(s) acted, executed the instrument.

WITNESS my hand and official seal.

Notary Public

RECEIVED
BLM & STATE OFFICE
2016 JUN 11 P 1:59
PHOENIX, ARIZONA

GERALD GORDON
1984 W SR 10
Lake Village, IN, 46349

5 9 1 2 3 4 5 6 7 8 9 10 11 12

06 JUL 2016 1749 L

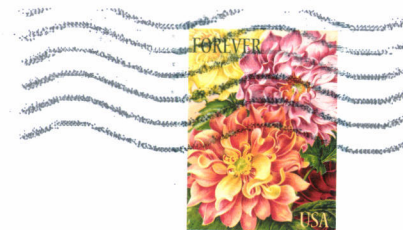

RECEIVED
BLM AT STATE OFFICE

2016 JUL 11 P 1:51

PHOENIX, ARIZONA

Bureau of Land Management
ONE N. Central Ave. Suite 800
Phoenix, AZ, 85004-4427

85004-442700



United States Department of the Interior
Bureau of Land Management
 DIV OF LANDS, MINRLS & ENERGY
 ONE N CENTRAL AVE
 PHOENIX, AZ 85004 -4427
 Phone: 602-417-9200

Receipt

No: 3604284

Transaction #: 3707707	
Date of Transaction: 07/12/2016	
CUSTOMER:	
GERALD GORDON 1984 W STATE ROAD 10 LAKE VILLAGE, IN 46349-9341 US	

LINE #	QTY	DESCRIPTION	REMARKS	UNIT PRICE	TOTAL
1	1.00	LOCATABLE MINERALS / MINING CLAIMS- NOT NEW-UNADJUD, ONE AUTH NO. ONLY / MINING CLAIM MONEY RECEIVED CASES: AMC437121/\$20.00	QCD - 2	- n/a -	20.00
TOTAL:					\$20.00

PAYMENT INFORMATION			
1	AMOUNT:	20.00	POSTMARKED: 07/06/2016
	TYPE:	CHECK	RECEIVED: 07/11/2016
	CHECK NO:	4036	
	NAME:	BROWN, TAHARA D 1984 W STATE ROAD 10 LAKE VILLAGE IN 46349-9341 US	

REMARKS

This receipt was generated by the automated BLM Collections and Billing System and is a paper representation of a portion of the official electronic record contained therein.

GERALD GORDON CALLED ON 15 AUG 16 AND VERIFIED KENNETH WAGNER'S ADDRESS, NEW AREA SO NOT, AND PHONE#. PROCESSED 396 17 Aug 16 JCS

ENTERED
 AUG 17 2016
 BY: *JCS*

SENDER: COMPLETE THIS SECTION

- Complete items 1, 2, and 3.
- Print your name and address on the reverse so that we can return the card to you.
- Attach this card to the back of the mailpiece, or on the front if space permits.

1. Article Addressed to:

GERALD GORDON
 1984 W SR 10
 LAKE VILLAGE IN 46349
 920/IO/AMC437117



9590 9402 1831 6104 4740 65

2. Article Number (Transfer from service label)

7015 1520 0002 6611 0366

COMPLETE THIS SECTION ON DELIVERY**A. Signature****X**
 Agent Addressee**B. Received by (Printed Name)**
C. Date of Delivery**D. Is delivery address different from item 1?** Yes

If YES, enter delivery address below:

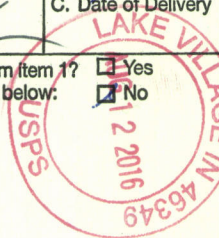
 No**3. Service Type**

- Adult Signature
- Adult Signature Restricted Delivery
- Certified Mail®
- Certified Mail Restricted Delivery
- Collect on Delivery
- Collect on Delivery Restricted Delivery

- Priority Mail Express®
- Registered Mail™
- Registered Mail Restricted Delivery
- Return Receipt for Merchandise
- Signature Confirmation™
- Signature Confirmation Restricted Delivery

Mail
 Mail Restricted Delivery
 500)

USPS TRACKING #

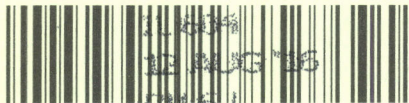

First-Class Mail
Postage & Fees Paid
USPS
Permit No. G-10

9590 9402 1831 6104 4740 65

United States
Postal Service

• Sender: Please print your name, address, and ZIP+4® in this box •

UNITED STATES
DEPARTMENT OF THE INTERIOR
Bureau of Land Management
Arizona State Office
One N. Central Avenue, Suite 800
Phoenix, AZ 85004-4427

PHOENIX, ARIZONA
2016 AUG 15 P 2:44
RECEIVED
BLM AZ STATE OFFICE





United States Department of the Interior



BUREAU OF LAND MANAGEMENT

Arizona State Office

One North Central Avenue, Suite 800

Phoenix, Arizona 85004-4427

www.blm.gov/az/

AUG 0 1 2016

In Reply Refer To:

3800 (9200) IO

AMC437117

CERTIFIED MAIL – RETURN RECEIPT REQUESTED 7015 1520 0002 6611 0366

NOTICE

GERALD GORDON : This Decision Affects Those Claims
1984 W SR 10 : Shown in the Block Below.
LAKE VILLAGE, IN 46349 :

AMC437118; AMC437121
BURIED TREASURE; GOLD PATCH

Transfer(s) Not Processed

A conveyance document to transfer ownership of the mining claim(s) listed above was received by the Bureau of Land Management (BLM) Arizona State Office. The transfer(s) of ownership cannot be processed for the following reason(s):

We received your request to process a Quitclaim Deed; however, the address provided for Mr. Kenneth G. Wagner cannot be verified. Please submit Mr Wagner's correct address and telephone number in order to finish processing the transfer of interest.

If appropriate, please submit a corrected conveyance document, required documents, or additional fees, within 30 days of your receipt of this notice. If the required information is not received within the 30-day timeframe, no further action will be taken, and the BLM will retain the non-refundable processing fees submitted.

If additional information is required, please contact Iran Ortega at 602-417-9355. Please include your AMC serial number(s) on all correspondence.

Rebecca Heick

Rebecca Heick
Deputy State Director
Lands, Minerals and Energy Division

SENDER: COMPLETE THIS SECTION

- Complete items 1, 2, and 3.
- Print your name and address on the reverse so that we can return the card to you.
- Attach this card to the back of the mailpiece, or on the front if space permits.

1. Article Addressed to:
 GERALD GORDON
 1984 W SR 10
 LAKE VILLAGE IN 46349
 920/IO/AMC437117



9590 9402 1831 6104 4740 65

2. Article Number (Transfer from service label)

7015 1520 0002 6611 0366

COMPLETE THIS SECTION ON DELIVERY

A. Signature

X *Gerald Gordon*

- Agent
- Addressee

B. Received by (Printed Name)

Gerald Gordon

C. Date of Delivery

Aug 12 2016

D. Is delivery address different from item 1? If YES, enter delivery address below:

- Yes
- No

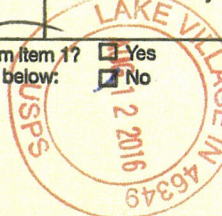

3. Service Type

- Adult Signature
- Adult Signature Restricted Delivery
- Certified Mail®
- Certified Mail Restricted Delivery
- Collect on Delivery
- Collect on Delivery Restricted Delivery
- First-Class Mail
- First-Class Mail Restricted Delivery (50)
- Priority Mail Express®
- Registered Mail™
- Registered Mail Restricted Delivery
- Return Receipt for Merchandise
- Signature Confirmation™
- Signature Confirmation Restricted Delivery

PS Form 3811, July 2015 PSN 7530-02-000-9053

Domestic Return Receipt

USPS TRACKING #

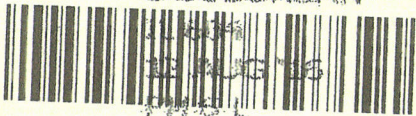

9590 9402 1831 6104 4740 65

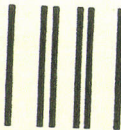

First-Class Mail
 Postage & Fees Paid
 USPS
 Permit No. G-10

United States Postal Service

• Sender: Please print your name, address, and ZIP+4® in this box •

PHOENIX, ARIZONA
 2015 AUG 15 P 2:44
 RECEIVED
 BLM AZ STATE OFFICE

UNITED STATES
 DEPARTMENT OF THE INTERIOR
 Bureau of Land Management
 Arizona State Office
 One N. Central Avenue, Suite 800
 Phoenix, AZ 85004-4427

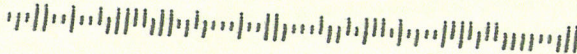

TO: UNITED STATES DEPARTMENT OF THE INTERIOR
BUREAU OF LAND MANAGEMENT
ONE N. CENTRAL AVE SUITE 800
PHOENIX, AZ, 85004-4427

437117

July 5th, 2016

NOTICE OF CHANGE IN OWNERSHIP OF MINING CLAIM

This letter and enclosed quitclaim deed, and check for the \$10. transfer fee, serves as notice that the:

AMC 437120 DIG IT

unpatented mining claim(s) were transferred to the new owner:

CRAIG A. MILDEN
924 JEFFERSON ST.
MALVERN, AR, 72104

by instrument of quitclaim deed.

Sincerely,

GERALD GORDON



Enclosed:
Notification letter
Quitclaim deed
Transfer fee of \$10.

RECEIVED
BLM AZ STATE OFFICE
2016 JUL 11 P 1:51
PHOENIX, ARIZONA

ENTERED
JUL 18 2016
BY: 

When recorded, mail to:

Name: **Craig A. Milden**

Address: **924 Jefferson St.**

City/State/Zip Code: **Malvern, AR, 72104**

Space above this line for Recorder's use

QUITCLAIM DEED

KNOW ALL MEN BY THESE PRESENTS:

That I(we), **Gerald Gordon**, the undersigned, for the consideration of Ten Dollars (\$10.00), and other valuable considerations, do hereby release, remise, and forever quitclaim unto **Craig A. Milden, of 924 Jefferson St, Malvern, AR, 72104**

all right, title and interest in that certain Property situated in **Yavapai** County, State of **Arizona**, and described as follows:

the unpatented federal mining claim AMC437120 Dig It, as described in document 2016-0012163 in the Yavapai County Recorders Office.

Legal: E1/2 SW1/4 SE1/4 SEC. 28 T10N R5W, GSRB&M, AZ

PHOENIX, ARIZONA
2016 JUL 11 10:57
BLM AVE OFFICE
REC'D
**NO TRANSFER NECESSARY
EXEMPT UNDER ARS 11-1134
A6**

IN WITNESS WHEREOF, I(we) have hereunto set my(our) hand(s) and seal this **24TH** day of **JUNE**, **2016**.

GERALD GORDON
Printed Name of Releasor

[Handwritten Signature]
Signature of Releasor

Printed Name of Releasor

Signature of Releasor

Printed Name of Witness (if required by State Laws)

Signature of Witness (if required by State Laws)

ACKNOWLEDGMENT
(States Other Than California)

State of INDIANA)
County of Newton) ss.

On this 24TH day of JUNE, 2016, before me, the undersigned Notary Public, personally appeared GERALD GORDON

known to me to be the individual(s) who executed the foregoing instrument and acknowledged the same to be his(her)(their) free act and deed.

My Commission Expires: 10/17/2018 Susan V. Wojtas
Notary Public

If acknowledged in the State of Florida, complete section(s) below:

(Releasor) Personally Known (or) Produced Identification

If applicable, Type of Identification Produced: _____



SUSAN V. WOJTAS
NOTARY PUBLIC - NEWTON COUNTY
MY COMMISSION EXPIRES OCTOBER 17, 2018

(Co-Releasor) Personally Known (or) Produced Identification

If applicable, Type of Identification Produced: _____

ACKNOWLEDGMENT
(State Of California)

State of California)
County of _____) ss.

On this _____ day of _____, _____, before me, _____, the undersigned Notary Public, personally appeared,

personally known to me (or proved to me on the basis of satisfactory evidence) to be the person(s) whose name(s) is(are) subscribed to the attached instrument and acknowledged to me that he(he)(they) executed the same in his(her)(their) authorized capacity(ies), and that by his(her)(their) signature(s) on the instrument, the person(s) or the entity upon behalf of which the person(s) acted, executed the instrument.

WITNESS my hand and official seal.

Notary Public

RECEIVED
BLM AUSTIN OFFICE
2016 JUL 11 P 1:51
PHOENIX, ARIZONA

GERALD GORDON
1984 W SR 10
Lake Village, IN, 46349

S 53 151100000 11 8004

06 JUL 2015 PH 11



RECEIVED
BLM NATIONAL OFFICE

2015 JUL 11 P 1:51

PHOENIX, ARIZONA

Bureau of Land Management
ONE N. Central Ave. Suite 800
Phoenix, AZ, 85004-4427

85004-442700



United States Department of the Interior
Bureau of Land Management
 DIV OF LANDS, MINRLS & ENERGY
 ONE N CENTRAL AVE
 PHOENIX, AZ 85004 -4427
 Phone: 602-417-9200

Receipt

No: 3604288

Transaction #: 3707712	
Date of Transaction: 07/12/2016	
CUSTOMER:	
GERALD GORDON 1984 W STATE ROAD 10 LAKE VILLAGE, IN 46349-9341 US	

LINE #	QTY	DESCRIPTION	REMARKS	UNIT PRICE	TOTAL
1	1.00	LOCATABLE MINERALS / MINING CLAIMS- NOT NEW-UNADJUD, ONE AUTH NO. ONLY / MINING CLAIM MONEY RECEIVED CASES: AMC437120/\$10.00	QCD - 1	- n/a -	10.00
TOTAL:					\$10.00

PAYMENT INFORMATION				
1	AMOUNT:	10.00	POSTMARKED:	07/06/2016
	TYPE:	CHECK	RECEIVED:	07/11/2016
	CHECK NO:	4034		
	NAME:	BROWN, TAHARA D 1984 W STATE ROAD 10 LAKE VILLAGE IN 46349-9341 US		

REMARKS

This receipt was generated by the automated BLM Collections and Billing System and is a paper representation of a portion of the official electronic record contained therein.

NOTICE!!

These documents have been scanned!

Do not place un-scanned documents beneath this notice!

Do not remove this notice from this file!

GPO Jacket No. 560-102
Print Order 61540
Rise Business Services, LLC
Job=AZ15 5/2/2019



Box Number= AZ15019



Claim Begin-End: AMC437117-AMC437124

4 Annual Filings



AZ15019-25

AMC436731-AMC437154

DEPARTMENT OF THE INTERIOR
BUREAU OF LAND MANAGEMENT
MINING CLAIMS

Run Date/Time: 9/24/2020

MC Maintenance Fees Paid Through the BLM Pay Portal
(by Date Paid)

Page 1 Of 1

CBS Receipt: 4771461

Printed For Lead File # AMC437117

Agency Tracking ID: 1596048307

Assessment Year: 2021

Number of BLM Serial Nr: 1

Paid On: 7/29/2020

Total Amount Paid:\$165.00

Message: :

Claim Name	BLM Serial No	Lead File No	Amount Paid
LUCKY LADY	AMC437123	AMC437117	\$165.00

United States Department of the Interior
Bureau of Land Management
 BUSINESS & SUPPORT SVCS DIV
 ONE N CENTRAL AVE SUITE 800
 PHOENIX, AZ 85004 -4427
 Phone: 602-417-9200

Receipt	
No:	4771461

Transaction #: 4898283	
Date of Transaction: 07/29/2020	
CUSTOMER:	
	KEVIN P. CONTRERAS 4229 N 19TH PL PHOENIX, AZ 85016 US

LINE #	QTY	DESCRIPTION	REMARKS	UNIT PRICE	TOTAL
1	1.00	LOCATABLE MINERALS / MINING CLAIMS- NOT NEW-UNADJUD, ONE AUTH NO. ONLY / MINING CLAIM MONEY RECEIVED CASES: AMC437123/\$165.00		- n/a -	165.00
TOTAL:					\$165.00

PAYMENT INFORMATION				
NOTE: Items will appear on credit card statement as "BLM O Mining Claim".				
1	AMOUNT:	165.00	POSTMARKED:	N/A
	TYPE:	CREDIT CARD	RECEIVED:	07/29/2020
	NAME:	KEVIN P. CONTRERAS 4229 N 19TH PL PHOENIX AZ 85016 US		
	CARD NO:	XXXXXXXXXXXX3419	AUTH CODE:	029452
	NAME ON CARD:	KEVIN P. CONTRERAS		
	SIGNATURE:	INTERNET		

REMARKS

This receipt was generated by the automated BLM Collections and Billing System and is a paper representation of a portion of the official electronic record contained therein.

DEPARTMENT OF THE INTERIOR
BUREAU OF LAND MANAGEMENT
MINING CLAIMS

Run Date/Time: 10/4/2019

MC Maintenance Fees Paid Through the BLM Pay Portal
(by Date Paid)

Page 2 Of 2

CBS Receipt: 4549467

Printed For Lead File # AMC437117

Agency Tracking ID: 1567200201

Assessment Year: 2020

Number of BLM Serial Nr: 1

Paid On: 8/30/2019

Total Amount Paid: \$165.00

Claim Name	BLM Serial No	Lead File No	Amount Paid
CUINAZ	AMC437119	AMC437117	\$165.00

United States Department of the Interior
Bureau of Land Management
 BUSINESS & SUPPORT SVCS DIV
 ONE N CENTRAL AVE SUITE 800
 PHOENIX, AZ 85004 -4427
 Phone: 602-417-9200

Receipt	
No:	4549467

Transaction #: 4670497	
Date of Transaction: 08/30/2019	
CUSTOMER:	
	ANITA BOUGIE 223 E SUPERIOR STREET MUNISING, MI 49862 US

LINE #	QTY	DESCRIPTION	REMARKS	UNIT PRICE	TOTAL
1	1.00	LOCATABLE MINERALS / MINING CLAIMS- NOT NEW-UNADJUD, ONE AUTH NO. ONLY / MINING CLAIM MONEY RECEIVED CASES: AMC437119/\$165.00		- n/a -	165.00
TOTAL:					\$165.00

PAYMENT INFORMATION			
NOTE: Items will appear on credit card statement as "BLM O Mining Claim".			
1	AMOUNT:	165.00	POSTMARKED: N/A
	TYPE:	CREDIT CARD	RECEIVED: 08/30/2019
	NAME:	ANITA BOUGIE 223 E SUPERIOR STREET MUNISING MI 49862 US	
	CARD NO:	XXXXXXXXXXXX2670	AUTH CODE: 030091
	NAME ON CARD:	ANITA BOUGIE	
	SIGNATURE:	INTERNET	

REMARKS

This receipt was generated by the automated BLM Collections and Billing System and is a paper representation of a portion of the official electronic record contained therein.

DEPARTMENT OF THE INTERIOR
BUREAU OF LAND MANAGEMENT
MINING CLAIMS

Run Date/Time: 10/3/2019

MC Maintenance Fees Paid Through the BLM Pay Portal
(by Date Paid)

Page 2 Of 2

CBS Receipt: 4539484

Printed For Lead File # AMC437117

Agency Tracking ID: 1566419412

Assessment Year: 2020

Number of BLM Serial Nr: 1

Paid On: 8/21/2019

Total Amount Paid: \$165.00

Claim Name	BLM Serial No	Lead File No	Amount Paid
GOLD PEAK	AMC437122	AMC437117	\$165.00

United States Department of the Interior
Bureau of Land Management
 BUSINESS & SUPPORT SVCS DIV
 ONE N CENTRAL AVE SUITE 800
 PHOENIX, AZ 85004 -4427
 Phone: 602-417-9200

Receipt	
No:	4539484

Transaction #: 4660427	
Date of Transaction: 08/21/2019	
CUSTOMER:	
	WESLEY G. DAY NOT APPLICABLE DENVER,CO 80225 US

LINE #	QTY	DESCRIPTION	REMARKS	UNIT PRICE	TOTAL
1	1.00	LOCATABLE MINERALS / MINING CLAIMS- NOT NEW-UNADJUD,ONE AUTH NO. ONLY / MINING CLAIM MONEY RECEIVED CASES: AMC437122/\$165.00		- n/a -	165.00
TOTAL:					\$165.00

PAYMENT INFORMATION			
1	AMOUNT:	165.00	POSTMARKED: N/A
	TYPE:	EFT	RECEIVED: 08/21/2019
	NAME:	WESLEY G. DAY NOT APPLICABLE DENVER CO 80225 US	

REMARKS

This receipt was generated by the automated BLM Collections and Billing System and is a paper representation of a portion of the official electronic record contained therein.

UNITED STATES
DEPARTMENT OF THE INTERIOR
BUREAU OF LAND MANAGEMENT

437117

CREDIT CARD PAYMENT
For Mining Claim Maintenance Fee

THIS IS A CHANGE OF ADDRESS

TELEPHONE SUBMISSION - ACCURACY OF THE BELOW INFORMATION IS THE RESPONSIBILITY OF THE CLAIMANT/OWNER

NAME MICHAEL R. BACHYNSKI
ADDRESS 7808 W. PALMAIRE AVE
CITY BLENDALE STATE AZ ZIP 85303
PHONE # 623 - 552-1553

SEND RECEIPT TO Above address
 Other (Include Name and Mailing Address):

AMC NUMBER
437124

CLAIM/SITE NAME
YELLOW ROCK

1 # of Claim/Site
x 165.00 Each
\$ 165.00 Total Charged PER (INITIALS)

RECEIPT # 4525529

DATE STAMP

RECEIVED
STATE OFFICE
2019 AUG -5 A 9:16
PHOENIX, ARIZONA

***** FOR OFFICIAL USE ONLY *****
DATE _____ INITIALS _____ VERIFIED _____

ENTERED
AUG 07 2019
BY: [Signature]

United States Department of the Interior
Bureau of Land Management
 DIV OF LANDS, MINRLS & ENERGY
 ONE N CENTRAL AVE
 PHOENIX, AZ 85004 -4427
 Phone: 602-417-9200

Receipt	
No:	4525529

Transaction #: 4646246
Date of Transaction: 08/06/2019

CUSTOMER:	
MICHAEL BACHYNSKI	7808 W PALMAIRE AVE GLENDALE, AZ 85303-2429 US

LINE #	QTY	DESCRIPTION	REMARKS	UNIT PRICE	TOTAL
1	1.00	LOCATABLE MINERALS / MINING CLAIMS- NOT NEW-UNADJUD, ONE AUTH NO. ONLY / MINING CLAIM MONEY RECEIVED CASES: AMC437124/\$165.00	2020 MAINT/1	- n/a -	165.00
TOTAL:					\$165.00

PAYMENT INFORMATION																									
NOTE: Items will appear on credit card statement as "Bureau of Land Mgmt CO".																									
1	<table border="1"> <tr> <td>AMOUNT:</td> <td>165.00</td> <td>POSTMARKED:</td> <td>N/A</td> </tr> <tr> <td>TYPE:</td> <td>CREDIT CARD</td> <td>RECEIVED:</td> <td>08/06/2019</td> </tr> <tr> <td>NAME:</td> <td colspan="3">BACHYNSKI, MICHAEL 7808 W PALMAIRE AVE GLENDALE AZ 85303-2429 US</td> </tr> <tr> <td>CARD NO:</td> <td>XXXXXXXXXXXX0083</td> <td>AUTH CODE:</td> <td>02426Z</td> </tr> <tr> <td>NAME ON CARD:</td> <td colspan="3">MICHAEL R BACHYNSKI</td> </tr> <tr> <td>SIGNATURE:</td> <td colspan="3">OVER THE PHONE</td> </tr> </table>	AMOUNT:	165.00	POSTMARKED:	N/A	TYPE:	CREDIT CARD	RECEIVED:	08/06/2019	NAME:	BACHYNSKI, MICHAEL 7808 W PALMAIRE AVE GLENDALE AZ 85303-2429 US			CARD NO:	XXXXXXXXXXXX0083	AUTH CODE:	02426Z	NAME ON CARD:	MICHAEL R BACHYNSKI			SIGNATURE:	OVER THE PHONE		
AMOUNT:	165.00	POSTMARKED:	N/A																						
TYPE:	CREDIT CARD	RECEIVED:	08/06/2019																						
NAME:	BACHYNSKI, MICHAEL 7808 W PALMAIRE AVE GLENDALE AZ 85303-2429 US																								
CARD NO:	XXXXXXXXXXXX0083	AUTH CODE:	02426Z																						
NAME ON CARD:	MICHAEL R BACHYNSKI																								
SIGNATURE:	OVER THE PHONE																								

REMARKS

This receipt was generated by the automated BLM Collections and Billing System and is a paper representation of a portion of the official electronic record contained therein.

DEPARTMENT OF THE INTERIOR
BUREAU OF LAND MANAGEMENT
MINING CLAIMS

Run Date/Time: 9/11/2018

MC Maintenance Fees Paid Through the BLM Pay Portal
(by Date Paid)

Page 191 Of 723

CBS Receipt: 4243304

Printed For Lead File # **AMC437117**

Agency Tracking ID: 1535064895

Assessment Year: 2019

Paid On: 8/23/2018

Number of BLM Serial Nr: 1

Total Amount Paid: \$155.00

Claim Name	BLM Serial No	Lead File No	Amount Paid
BOULDER MOVE	AMC437117	AMC437117	\$155.00

United States Department of the Interior
Bureau of Land Management
 BUSINESS & SUPPORT SVCS DIV
 ONE N CENTRAL AVE SUITE 800
 PHOENIX, AZ 85004 -4427
 Phone: 602-417-9200

Receipt

No: 4243304

Transaction #: 4358738	
Date of Transaction: 08/23/2018	
CUSTOMER:	
STEVEN H. WILLIAMS PO BOX 181 CONGRESS, AZ 85332 US	

LINE #	QTY	DESCRIPTION	REMARKS	UNIT PRICE	TOTAL
1	1.00	LOCATABLE MINERALS / MINING CLAIMS- NOT NEW-UNADJUD, ONE AUTH NO. ONLY / MINING CLAIM MONEY RECEIVED CASES: AMC437117/\$155.00		- n/a -	155.00
TOTAL:					\$155.00

PAYMENT INFORMATION			
NOTE: Items will appear on credit card statement as "BLM O Mining Claim".			
1	AMOUNT:	155.00	POSTMARKED: N/A
	TYPE:	CREDIT CARD	RECEIVED: 08/23/2018
	NAME:	STEVEN H. WILLIAMS PO BOX 181 CONGRESS AZ 85332 US	
	CARD NO:	XXXXXXXXXXXX4471	AUTH CODE: 04364B
	NAME ON CARD:	STEVEN H. WILLIAMS	
	SIGNATURE:		

REMARKS

This receipt was generated by the automated BLM Collections and Billing System and is a paper representation of a portion of the official electronic record contained therein.

DEPARTMENT OF THE INTERIOR
BUREAU OF LAND MANAGEMENT
MINING CLAIMS

Run Date/Time: 9/26/2018

MC Maintenance Fees Paid Through the BLM Pay Portal
(by Date Paid)

Page 3 Of 3

CBS Receipt: 4244383

Printed For Lead File # AMC437117

Agency Tracking ID: 1535228138

Assessment Year: 2019

Paid On: 8/25/2018

Number of BLM Serial Nr: 3

Total Amount Paid: \$465.00

Claim Name	BLM Serial No	Lead File No	Amount Paid
HILL GOLD	AMC432478	AMC432478	\$155.00
BURIED TREASURE	AMC437118	AMC437117	\$155.00
GOLD PATCH	AMC437121	AMC437117	\$155.00

United States Department of the Interior
Bureau of Land Management
 BUSINESS & SUPPORT SVCS DIV
 ONE N CENTRAL AVE SUITE 800
 PHOENIX, AZ 85004 -4427
 Phone: 602-417-9200

Receipt

No: 4244383

Transaction #: 4359831	
Date of Transaction: 08/25/2018	
CUSTOMER:	
KENNETH WAGNER 8460 W. REDROCK RD. KIRKLAND, AZ 86332 US	

LINE #	QTY	DESCRIPTION	REMARKS	UNIT PRICE	TOTAL
1	1.00	LOCATABLE MINERALS / MINING CLAIMS-NOT NEW-UNADJUD, ONE AUTH NO. ONLY / MINING CLAIM MONEY RECEIVED CASES: AMC437118/\$465.00		- n/a -	465.00
TOTAL:					\$465.00

PAYMENT INFORMATION				
NOTE: Items will appear on credit card statement as "BLM O Mining Claim".				
1	AMOUNT:	465.00	POSTMARKED:	N/A
	TYPE:	CREDIT CARD	RECEIVED:	08/25/2018
	NAME:	KENNETH WAGNER 8460 W. REDROCK RD. KIRKLAND AZ 86332 US		
	CARD NO:	XXXXXXXXXXXX5089	AUTH CODE:	02558B
	NAME ON CARD:	KENNETH WAGNER		
	SIGNATURE:			

REMARKS

This receipt was generated by the automated BLM Collections and Billing System and is a paper representation of a portion of the official electronic record contained therein.

UNITED STATES
DEPARTMENT OF THE INTERIOR
BUREAU OF LAND MANAGEMENT

437117

CREDIT CARD PAYMENT
For Mining Claim Maintenance Fee

THIS IS A CHANGE OF ADDRESS

TELEPHONE SUBMISSION - ACCURACY OF THE BELOW INFORMATION IS THE RESPONSIBILITY OF THE CLAIMANT/OWNER

NAME SANDRA WINRIGHT
ADDRESS 603 GRANT ROAD
CITY GERMFASK STATE MI ZIP 49836
PHONE # 906 - 202-9044

SEND RECEIPT TO Above address
 Other (include Name and Mailing Address):

AMC NUMBER
437119

CLAIM/SITE NAME
C U IN AZ

1 # of Claim/Site
x 155.00 Each
\$ 155.00 Total Charged EW (INITIALS)

RECEIPT # 4239475

DATE STAMP

ENTERED
AUG 21 2018
BY: RAM

RECEIVED
BLM AZ STATE OFFICE
2018 AUG 20 A 9:22
PHOENIX, ARIZONA

***** FOR OFFICIAL USE ONLY *****

DATE _____ INITIALS _____ VERIFIED _____

United States Department of the Interior
Bureau of Land Management
 DIV OF LANDS, MINRLS & ENERGY
 ONE N CENTRAL AVE
 PHOENIX, AZ 85004 -4427
 Phone: 602-417-9200

Receipt

No: 4239475

Transaction #: 4354874	
Date of Transaction: 08/20/2018	
CUSTOMER:	
SANDRA WINRIGHT 603 GRANT RD GERMFASK,MI 49836-9030 US	

LINE #	QTY	DESCRIPTION	REMARKS	UNIT PRICE	TOTAL
1	1.00	LOCATABLE MINERALS / MINING CLAIMS- NOT NEW-UNADJUD, ONE AUTH NO. ONLY / MINING CLAIM MONEY RECEIVED CASES: AMC437119/\$155.00	2019 MAINT (1)	- n/a -	155.00
TOTAL:					\$155.00

PAYMENT INFORMATION			
NOTE: Items will appear on credit card statement as "Bureau of Land Mgmt CO".			
1	AMOUNT:	155.00	POSTMARKED: N/A
	TYPE:	CREDIT CARD	RECEIVED: 08/20/2018
	NAME:	WINRIGHT, SANDRA 603 GRANT RD GERMFASK MI 49836-9030 US	
	CARD NO:	XXXXXXXXXXXX1972	AUTH CODE: 025416
	NAME ON CARD:	ANITA BOUGIE	
	SIGNATURE:		

REMARKS

This receipt was generated by the automated BLM Collections and Billing System and is a paper representation of a portion of the official electronic record contained therein.

UNITED STATES
DEPARTMENT OF THE INTERIOR
BUREAU OF LAND MANAGEMENT

437111

CREDIT CARD PAYMENT
For Mining Claim Maintenance Fee

TELEPHONE SUBMISSION - ACCURACY OF THE BELOW INFORMATION IS THE RESPONSIBILITY OF THE CLAIMANT/OWNER

NAME Michael R. Bashynski
ADDRESS 7808 W. Palmyra Av
CITY Glendale STATE AZ ZIP 85303
PHONE # 623 - 552 1553

SEND RECEIPT TO Above address
 Other (Include Name and Mailing Address):

AMC NUMBER

AMC 437124

CLAIM/SITE NAME

ENTERED
AUG 14 2018
BY: SC

ENTERED
AUG 14 2018
BY:

1 # of Claim/Site
x 155.00 Each
\$ 155.00 Total Charged DER (INITIALS)

RECEIPT # 4233111

DATE STAMP

NO. OF CLAIMS 1
AMOUNT 155.00
RECEIPT NO. 4233111
INIT. DER

BLM-ASO

PHOENIX, ARIZONA

2018 AUG 13 A 9:56

RECEIVED
BLM AZ STATE OFFICE

***** FOR OFFICIAL USE ONLY *****

DATE _____

INITIALS _____

VERIFIED _____

United States Department of the Interior
Bureau of Land Management
 DIV OF LANDS, MINRLS & ENERGY
 ONE N CENTRAL AVE
 PHOENIX, AZ 85004 -4427
 Phone: 602-417-9200

Receipt

No: 4233111

Transaction #: 4348445	
Date of Transaction: 08/13/2018	
CUSTOMER:	
MICHAEL BACHYNSKI 7808 W PALMAIRE AVE GLENDALE, AZ 85303-2429 US	

LINE #	QTY	DESCRIPTION	REMARKS	UNIT PRICE	TOTAL
1	1.00	LOCATABLE MINERALS / MINING CLAIMS-NOT NEW-UNADJUD, ONE AUTH NO. ONLY / MINING CLAIM MONEY RECEIVED CASES: AMC437124/\$155.00	2019 MAINT/1	- n/a -	155.00
TOTAL:					\$155.00

PAYMENT INFORMATION			
NOTE: Items will appear on credit card statement as "Bureau of Land Mgmt CO".			
1	AMOUNT:	155.00	POSTMARKED: N/A
	TYPE:	CREDIT CARD	RECEIVED: 08/13/2018
	NAME:	BACHYNSKI, MICHAEL 7808 W PALMAIRE AVE GLENDALE AZ 85303-2429 US	
	CARD NO:	XXXXXXXXXXXX0083	AUTH CODE: 97127Z
	NAME ON CARD:	MICHAEL R BACHYNSKI	
	SIGNATURE:		

REMARKS

This receipt was generated by the automated BLM Collections and Billing System and is a paper representation of a portion of the official electronic record contained therein.

Run Date: 08/01/18

Run Time: 05:44 PM

**DEPARTMENT OF THE INTERIOR
BUREAU OF LAND MANAGEMENT
MINING CLAIMS**

MC Maintenance Fees Paid Through the BLM Pay Portal

CBS Receipt: 4218096

Printed For Lead File # AMC437117

Agency Tracking ID: 1532396222

Assessment Year: 2019

Number of BLM Serial Nr: 1

Paid On: 07/23/2018

Total Amount Paid: \$155.00

Claim Name	BLM Serial No	Lead File No	Amount Paid
LUCKY LADY	AMC437123	AMC437117	\$155.00

United States Department of the Interior
Bureau of Land Management
 BUSINESS & SUPPORT SVCS DIV
 ONE N CENTRAL AVE SUITE 800
 PHOENIX, AZ 85004 -4427
 Phone: 602-417-9200

Receipt

No: 4218096

Transaction #: 4333255	
Date of Transaction: 07/23/2018	
CUSTOMER:	
KEVIN P. CONTRERAS 4229 N 19TH PL PHOENIX, AZ 85016 US	

LINE #	QTY	DESCRIPTION	REMARKS	UNIT PRICE	TOTAL
1	1.00	LOCATABLE MINERALS / MINING CLAIMS- NOT NEW-UNADJUD, ONE AUTH NO. ONLY / MINING CLAIM MONEY RECEIVED CASES: AMC437123/\$155.00		- n/a -	155.00
TOTAL:					\$155.00

PAYMENT INFORMATION			
NOTE: Items will appear on credit card statement as "BLM O Mining Claim".			
1	AMOUNT:	155.00	POSTMARKED: N/A
	TYPE:	CREDIT CARD	RECEIVED: 07/23/2018
	NAME:	KEVIN P. CONTRERAS 4229 N 19TH PL PHOENIX AZ 85016 US	
	CARD NO:	XXXXXXXXXXXX3419	AUTH CODE: 023534
	NAME ON CARD:	KEVIN P. CONTRERAS	
	SIGNATURE:		

REMARKS

This receipt was generated by the automated BLM Collections and Billing System and is a paper representation of a portion of the official electronic record contained therein.

Run Date: 08/21/17

Run Time: 09:47 AM

**DEPARTMENT OF THE INTERIOR
BUREAU OF LAND MANAGEMENT
MINING CLAIMS**

MC Maintenance Fees Paid Through the BLM Pay Portal

CBS Receipt: 3941189

Printed For Lead File # AMC437117

Agency Tracking ID: 1502911393

Number of BLM Serial Nr: 3

Assessment Year: 2018

Total Amount Paid: \$465.00

Paid On: 08/16/2017

Claim Name	BLM Serial No	Lead File No	Amount Paid
HILL GOLD	AMC432478	AMC432478	\$155.00
BURIED TREASURE	AMC437118	AMC437117	\$155.00
GOLD PATCH	AMC437121	AMC437117	\$155.00

**United States Department of the Interior
Bureau of Land Management
BUSINESS & SUPPORT SVCS DIV
ONE N CENTRAL AVE SUITE 800
PHOENIX, AZ 85004 -4427
Phone: 602-417-9200**

Receipt

No: 3941189

Transaction #: 4050851	
Date of Transaction: 08/16/2017	
CUSTOMER:	
KENNETH G WAGNER 8460 W REDROCK RD KIRKLAND, AZ 86332 US	

LINE #	QTY	DESCRIPTION	REMARKS	UNIT PRICE	TOTAL
1	1.00	LOCATABLE MINERALS / MINING CLAIMS- NOT NEW-UNADJUD, ONE AUTH NO. ONLY / MINING CLAIM MONEY RECEIVED CASES: AMC432478/\$465.00		- n/a -	465.00
TOTAL:					\$465.00

PAYMENT INFORMATION			
NOTE: Items will appear on credit card statement as "BLM O Mining Claim".			
1	AMOUNT:	465.00	POSTMARKED: N/A
	TYPE:	CREDIT CARD	RECEIVED: 08/16/2017
	NAME:	KENNETH G WAGNER 8460 W REDROCK RD KIRKLAND AZ 86332 US	
	CARD NO:	XXXXXXXXXXXX5089	AUTH CODE: 01614B
	NAME ON CARD:	KENNETH G WAGNER	
	EXPIRES:	07/2021	
	SIGNATURE:		

REMARKS

This receipt was generated by the automated BLM Collections and Billing System and is a paper representation of a portion of the official electronic record contained therein.

Run Date: 08/21/17

Run Time: 09:47 AM

**DEPARTMENT OF THE INTERIOR
BUREAU OF LAND MANAGEMENT
MINING CLAIMS**

MC Maintenance Fees Paid Through the BLM Pay Portal

CBS Receipt: 3941258

Printed For Lead File #AMC437117

Agency Tracking ID: 1502928048

Number of BLM Serial Nr: 1

Assessment Year: 2018

Paid On: 08/16/2017

Total Amount Paid: \$155.00

Claim Name	BLM Serial No	Lead File No	Amount Paid
BOULDER MOVE	AMC437117	AMC437117	\$155.00

United States Department of the Interior
Bureau of Land Management
 BUSINESS & SUPPORT SVCS DIV
 ONE N CENTRAL AVE SUITE 800
 PHOENIX, AZ 85004 -4427
 Phone: 602-417-9200

Receipt

No: 3941258

Transaction #: 4050920	
Date of Transaction: 08/16/2017	
CUSTOMER:	
STEVEN WILLIAMS P.O. BOX 181 CONGRESS, AZ 85332 US	

LINE #	QTY	DESCRIPTION	REMARKS	UNIT PRICE	TOTAL
1	1.00	LOCATABLE MINERALS / MINING CLAIMS- NOT NEW-UNADJUD, ONE AUTH NO. ONLY / MINING CLAIM MONEY RECEIVED CASES: AMC437117/\$155.00		- n/a -	155.00
TOTAL:					\$155.00

PAYMENT INFORMATION			
NOTE: Items will appear on credit card statement as "BLM O Mining Claim".			
1	AMOUNT:	155.00	POSTMARKED: N/A
	TYPE:	CREDIT CARD	RECEIVED: 08/16/2017
	NAME:	STEVEN WILLIAMS P.O. BOX 181 CONGRESS AZ 85332 US	
	CARD NO:	XXXXXXXXXXXX4471	AUTH CODE: 05440B
	NAME ON CARD:	STEVEN WILLIAMS	
	EXPIRES:	05/2019	
	SIGNATURE:		

REMARKS

This receipt was generated by the automated BLM Collections and Billing System and is a paper representation of a portion of the official electronic record contained therein.

UNITED STATES
DEPARTMENT OF THE INTERIOR
BUREAU OF LAND MANAGEMENT

437117

CREDIT CARD PAYMENT
For Mining Claim Maintenance Fee

THIS IS A CHANGE OF ADDRESS

TELEPHONE SUBMISSION - ACCURACY OF THE BELOW INFORMATION IS THE RESPONSIBILITY OF THE CLAIMANT/OWNER

NAME SANDRA K WINRIGHT
ADDRESS 318 E JEFFERSON ST
CITY GALLUP STATE NM ZIP 87301
PHONE # 505-908-8064

SEND RECEIPT TO Above address
 Other (Include Name and Mailing Address):

AMC NUMBER
AMC 437119

CLAIM/SITE NAME

1 # of Claim/Site
x 155.00 Each
\$ 155.00 Total Charged PER (INITIALS)

RECEIPT # 3967088

DATE STAMP

ENTERED
SEP 01 2017
BY: RAM

RECEIVED
PHOENIX, ARIZONA
2017 AUG 31 A 9:54
OFFICE

***** FOR OFFICIAL USE ONLY *****
DATE _____ INITIALS _____ VERIFIED _____

**DEPARTMENT OF THE INTERIOR
BUREAU OF LAND MANAGEMENT
MINING CLAIMS
(MASS) Serial Register Page**

Run Date/Time: 08/30/17 03:20 PM

Page 1 of 1

01 10-21-1976;090STAT0090;43USC1744

**Total Acres
20.000**

**Serial Number
AMC437119**

Case Type 384201: PLACER CLAIM

Claim Name: CUINAZ

**Lead File Number
AMC437117**

Case Disposition: ACTIVE

Required Maintenance Fee: \$155.00

Name & Address

Int Rel

WINRIGHT SANDRA K
318 E JEFFERSON ST GALLUP, NM 87301-5114

CLAIMANT

County / State

District

YAVAPAI County, AZ

PHOENIX DO

Mer Twp Rng Sec

Subdivision

14 0080N 0050W 011

SW

Act Date	Code	Action Text	Action Remarks	Receipt Number
03/09/2016	403	LOCATION DATE		
03/14/2016	395	RECORDATION NOTICE RECD	1	3515187
08/23/2016	782	MAINTENANCE FEE PAYMENT	2017;\$155	3638886
03/14/2016	484	LOCATION YEAR / MAINTENAN	2016;\$155	3515187
09/07/2016	393	DECISION/NOTICE ISSUED	ADDITIONAL INFO-STIPS	
09/26/2016	396	TRF OF INTEREST FILED	GORDON GERALD	3668104
09/22/2016	113	ADDITIONAL INFO RECEIVED	STATEMENT OF AGREEMNT	
07/27/2016	669	LAND STATUS CHECKED		
03/14/2016	501	ACCT ADV IN LEAD FILE	AMC437117-AMC437124;	

Line Nr Remarks

RECEIVED
BLM STATE OFFICE
2017 AUG 31 A 9:54
PHOENIX, ARIZONA

United States Department of the Interior
Bureau of Land Management
 DIV OF LANDS, MINRLS & ENERGY
 ONE N CENTRAL AVE
 PHOENIX, AZ 85004 -4427
 Phone: 602-417-9200

Receipt

No: 3967088

Transaction #: 4076975	
Date of Transaction: 08/31/2017	
CUSTOMER:	
SANDRA WINRIGHT 318 E JEFFERSON ST GALLUP, NM 87301-5114 US	

LINE #	QTY	DESCRIPTION	REMARKS	UNIT PRICE	TOTAL
1	1.00	LOCATABLE MINERALS / MINING CLAIMS- NOT NEW-UNADJUD, ONE AUTH NO. ONLY / MINING CLAIM MONEY RECEIVED CASES: AMC437119/\$155.00	2018 MAINT/1	- n/a -	155.00
TOTAL:					\$155.00

PAYMENT INFORMATION			
NOTE: Items will appear on credit card statement as "Bureau of Land Mgmt CO".			
1	AMOUNT:	155.00	POSTMARKED: N/A
	TYPE:	CREDIT CARD	RECEIVED: 08/31/2017
	NAME:	WINRIGHT, SANDRA 318 E JEFFERSON ST GALLUP NM 87301-5114 US	
	CARD NO:	XXXXXXXXXXXX2467	AUTH CODE: 862446
	NAME ON CARD:	SANDRA K WINRIGHT	
	EXPIRES:	05/2021	
	SIGNATURE:		

REMARKS

This receipt was generated by the automated BLM Collections and Billing System and is a paper representation of a portion of the official electronic record contained therein.

Run Date: 07/31/17

Run Time: 02:19 PM

**DEPARTMENT OF THE INTERIOR
BUREAU OF LAND MANAGEMENT
MINING CLAIMS**

MC Maintenance Fees Paid Through the BLM Pay Portal

CBS Receipt: 3905300

Printed For Lead File # AMC437117

Agency Tracking ID: 1501011966

Assessment Year: 2018

Number of BLM Serial Nr: 1

Paid On: 07/25/2017

Total Amount Paid: \$155.00

Claim Name	BLM Serial No	Lead File No	Amount Paid
LUCKY LADY	AMC437123	AMC437117	\$155.00

United States Department of the Interior
Bureau of Land Management
 BUSINESS & SUPPORT SVCS DIV
 ONE N CENTRAL AVE SUITE 800
 PHOENIX, AZ 85004 -4427
 Phone: 602-417-9200

Receipt

No: 3905300

Transaction #: 4014677	
Date of Transaction: 07/25/2017	
CUSTOMER:	
KEVIN P. CONTRERAS 4229 NORTH 19TH PL PHOENIX, AZ 85016 US	

LINE #	QTY	DESCRIPTION	REMARKS	UNIT PRICE	TOTAL
1	1.00	LOCATABLE MINERALS / MINING CLAIMS- NOT NEW-UNADJUD, ONE AUTH NO. ONLY / MINING CLAIM MONEY RECEIVED CASES: AMC437123/\$155.00		- n/a -	155.00
TOTAL:					\$155.00

PAYMENT INFORMATION			
NOTE: Items will appear on credit card statement as "BLM O Mining Claim".			
1	AMOUNT:	155.00	POSTMARKED: N/A
	TYPE:	CREDIT CARD	RECEIVED: 07/25/2017
	NAME:	KEVIN P. CONTRERAS 4229 NORTH 19TH PL PHOENIX AZ 85016 US	
	CARD NO:	XXXXXXXXXXXX3419	AUTH CODE: 025051
	NAME ON CARD:	KEVIN P. CONTRERAS	
	EXPIRES:	03/2022	
	SIGNATURE:		

REMARKS

This receipt was generated by the automated BLM Collections and Billing System and is a paper representation of a portion of the official electronic record contained therein.

UNITED STATES
DEPARTMENT OF THE INTERIOR
BUREAU OF LAND MANAGEMENT

437124

CREDIT CARD PAYMENT
For Mining Claim Maintenance Fee

THIS IS A CHANGE OF ADDRESS

TELEPHONE SUBMISSION - ACCURACY OF THE BELOW INFORMATION IS THE RESPONSIBILITY OF THE CLAIMANT/OWNER

NAME MICHAEL BACHYNSKI
ADDRESS 7808 W PALMIRE AVE
CITY GLENDALE STATE AZ ZIP 85303
PHONE # 623 - 552 - 1553

SEND RECEIPT TO Above address
 Other (Include Name and Mailing Address):

AMC NUMBER ~~XXXXXXXXXX~~ 437124 CLAIM/SITE NAME YELLOW ROCK

1 # of Claim/Site
x 155.00 Each
\$ 155.00 Total Charged PETZ (INITIALS)

RECEIPT # 3916376

DATE STAMP

ENTERED
AUG 02 2017
BY: RAM

RECEIVED
BLM AZ STATE OFFICE
2017 AUG - 1 P 12:52
PHOENIX, ARIZO

***** FOR OFFICIAL USE ONLY *****

DATE _____ INITIALS _____ VERIFIED _____

**DEPARTMENT OF THE INTERIOR
BUREAU OF LAND MANAGEMENT
MINING CLAIMS
(MASS) Serial Register Page**

Run Date/Time: 08/01/17 02:11 PM

Page 1 of 1

01 10-21-1976;090STAT0090;43USC1744

Total Acres

Serial Number

Case Type 384201: PLACER CLAIM

20.000

AMC437124

Claim Name: YELLOW ROCK

Lead File Number

Case Disposition: ACTIVE

AMC437117

Required Maintenance Fee: \$155.00

Name & Address

Int Rel

BACHYNSKI MICHAEL R
7808 W PALMAIRE AVE GLENDALE, AZ 85303-2429

CLAIMANT

County / State

District

YAVAPAI County, AZ

PHOENIX DO

Mer Twp Rng Sec

Subdivision

14 0080N 0050W 015

NE

Act Date	Code	Action Text	Action Remarks	Receipt Number
03/08/2016	403	LOCATION DATE		
03/14/2016	395	RECORDATION NOTICE RECD	1	3515187
08/22/2016	782	MAINTENANCE FEE PAYMENT	2017;\$155	3637053
03/14/2016	484	LOCATION YEAR / MAINTENAN	2016;\$155	3515187
08/22/2016	396	TRF OF INTEREST FILED	GORDON GERALD	3638420
07/27/2016	669	LAND STATUS CHECKED		
03/14/2016	501	ACCT ADV IN LEAD FILE	AMC437117-AMC437124;	

Line Nr Remarks

RECEIVED
 BLM AZ STATE OFFICE
 2017 AUG - 1 P 1:12
 PHOENIX, ARIZO

**United States Department of the Interior
Bureau of Land Management
DIV OF LANDS, MINRLS & ENERGY
ONE N CENTRAL AVE
PHOENIX, AZ 85004 -4427
Phone: 602-417-9200**

Receipt

No: 3916376

Transaction #: 4025827	
Date of Transaction: 08/01/2017	
CUSTOMER:	
MICHAEL BACHYNSKI 7808 W PALMAIRE AVE GLENDALE, AZ 85303-2429 US	

LINE #	QTY	DESCRIPTION	REMARKS	UNIT PRICE	TOTAL
1	1.00	LOCATABLE MINERALS / MINING CLAIMS- NOT NEW-UNADJUD, ONE AUTH NO. ONLY / MINING CLAIM MONEY RECEIVED CASES: AMC437124/\$155.00	2018 MAINT/1	- n/a -	155.00
TOTAL:					\$155.00

PAYMENT INFORMATION			
NOTE: Items will appear on credit card statement as "Bureau of Land Mgmt CO".			
1	AMOUNT:	155.00	POSTMARKED: N/A
	TYPE:	CREDIT CARD	RECEIVED: 08/01/2017
	NAME:	BACHYNSKI, MICHAEL 7808 W PALMAIRE AVE GLENDALE AZ 85303-2429 US	
	CARD NO:	XXXXXXXXXXXX8756	AUTH CODE: 02718A
	NAME ON CARD:	MICHAEL BACHYNSKI	
	EXPIRES:	07/2019	
	SIGNATURE:		

REMARKS

This receipt was generated by the automated BLM Collections and Billing System and is a paper representation of a portion of the official electronic record contained therein.

Run Date: 09/09/16

Run Time: 05:54 AM

**DEPARTMENT OF THE INTERIOR
BUREAU OF LAND MANAGEMENT
MINING CLAIMS**

MC Maintenance Fees Paid Through the BLM Pay Portal

CBS Receipt: 3639995

Printed For Lead File # **AMC437117**

Agency Tracking ID: 1472011519

Assessment Year: 2017

Number of BLM Serial Nr: 1

Paid On: 08/23/2016

Total Amount Paid: \$155.00

Claim Name	BLM Serial No	Lead File No	Amount Paid
GOLD PEAK	AMC437122	AMC437117	\$155.00

**United States Department of the Interior
Bureau of Land Management
BUSINESS & SUPPORT SVCS DIV
ONE N CENTRAL AVE SUITE 800
PHOENIX, AZ 85004 -4427
Phone: (602) 417-9200**

Receipt

No: 3639995

Transaction #: 3743927	
Date of Transaction: 08/24/2016	
CUSTOMER:	
WESLEY DAY PO BOX 1411 DOLAN SPRINGS, AZ 86441 US	

LINE #	QTY	DESCRIPTION	REMARKS	UNIT PRICE	TOTAL
1	1.00	LOCATABLE MINERALS / MINING CLAIMS- NOT NEW-UNADJUD, ONE AUTH NO. ONLY / MINING CLAIM MONEY RECEIVED CASES: AMC437122/\$155.00		- n/a -	155.00
TOTAL:					\$155.00

PAYMENT INFORMATION			
NOTE: Items will appear on credit card statement as "BLM O Mining Claim".			
1	AMOUNT:	155.00	POSTMARKED: N/A
	TYPE:	CREDIT CARD	RECEIVED: 08/24/2016
	NAME:	WESLEY DAY PO BOX 1411 DOLAN SPRINGS AZ 86441 US	
	CARD NO:	XXXXXXXXXXXX2779	AUTH CODE: 191910
	NAME ON CARD:	WESLEY DAY	
	EXPIRES:	03/2019	
	SIGNATURE:		

REMARKS

This receipt was generated by the automated BLM Collections and Billing System and is a paper representation of a portion of the official electronic record contained therein.

Run Date: 09/09/16

Run Time: 05:54 AM

**DEPARTMENT OF THE INTERIOR
BUREAU OF LAND MANAGEMENT
MINING CLAIMS**

MC Maintenance Fees Paid Through the BLM Pay Portal

CBS Receipt: 3638886

Printed For Lead File # **AMC437117**

Agency Tracking ID: 1471962794

Assessment Year: 2017

Number of BLM Serial Nr: 9

Paid On: 08/23/2016

Total Amount Paid: \$2,015.00

Claim Name	BLM Serial No	Lead File No	Amount Paid
HIGH GRADE	AMC381825	AMC381820	\$310.00
PROSPECTOR'S PARADISE	AMC396028	AMC396025	\$310.00
ANTELOPE BEND	AMC426213	AMC426212	\$310.00
PAY DIRT	AMC426218	AMC426212	\$310.00
DEVIL'S NEST 9	AMC427888	AMC427888	\$155.00
GOLD AMBITIONS	AMC436793	AMC436793	\$155.00
GOLD WATER	AMC436795	AMC436793	\$155.00
CUINAZ	AMC437119	AMC437117	\$155.00
LUCKY LADY	AMC437123	AMC437117	\$155.00

United States Department of the Interior
Bureau of Land Management
 BUSINESS & SUPPORT SVCS DIV
 ONE N CENTRAL AVE SUITE 800
 PHOENIX, AZ 85004 -4427
 Phone: (602) 417-9200

Receipt

No: 3638886

Transaction #: 3742801	
Date of Transaction: 08/23/2016	
CUSTOMER:	
GERALD GORDON P.O. BOX 800 CONGRESS, AZ 85332 US	

LINE #	QTY	DESCRIPTION	REMARKS	UNIT PRICE	TOTAL
1	1.00	LOCATABLE MINERALS / MINING CLAIMS- NOT NEW-UNADJUD, ONE AUTH NO. ONLY / MINING CLAIM MONEY RECEIVED CASES: AMC426213/\$2015.00		- n/a -	2015.00
TOTAL:					\$2,015.00

PAYMENT INFORMATION			
NOTE: Items will appear on credit card statement as "BLM O Mining Claim".			
1	AMOUNT:	2015.00	POSTMARKED: N/A
	TYPE:	CREDIT CARD	RECEIVED: 08/23/2016
	NAME:	GERALD GORDON P.O. BOX 800 CONGRESS AZ 85332 US	
	CARD NO:	XXXXXXXXXXXX4937	AUTH CODE: 782274
	NAME ON CARD:	GERALD GORDON	
	EXPIRES:	12/2019	
	SIGNATURE:		

REMARKS

This receipt was generated by the automated BLM Collections and Billing System and is a paper representation of a portion of the official electronic record contained therein.

Run Date: 09/09/16

Run Time: 05:54 AM

**DEPARTMENT OF THE INTERIOR
BUREAU OF LAND MANAGEMENT
MINING CLAIMS**

MC Maintenance Fees Paid Through the BLM Pay Portal

CBS Receipt: 3638868

Printed For Lead File # **AMC437117**

Agency Tracking ID: 1471969336

Assessment Year: 2017

Number of BLM Serial Nr: 1

Paid On: 08/23/2016

Total Amount Paid: \$155.00

Claim Name	BLM Serial No	Lead File No	Amount Paid
BOULDER MOVE	AMC437117	AMC437117	\$155.00

United States Department of the Interior
Bureau of Land Management
 BUSINESS & SUPPORT SVCS DIV
 ONE N CENTRAL AVE SUITE 800
 PHOENIX, AZ 85004 -4427
 Phone: (602) 417-9200

Receipt

No: 3638868

Transaction #: 3742783	
Date of Transaction: 08/23/2016	
CUSTOMER:	
GORDON GERALD 11265 W RUDDY DRIVE MARANA, AZ 85653 US	

LINE #	QTY	DESCRIPTION	REMARKS	UNIT PRICE	TOTAL
1	1.00	LOCATABLE MINERALS / MINING CLAIMS- NOT NEW-UNADJUD, ONE AUTH NO. ONLY / MINING CLAIM MONEY RECEIVED CASES: AMC437117/\$155.00		- n/a -	155.00
TOTAL:					\$155.00

PAYMENT INFORMATION			
NOTE: Items will appear on credit card statement as "BLM O Mining Claim".			
1	AMOUNT:	155.00	POSTMARKED: N/A
	TYPE:	CREDIT CARD	RECEIVED: 08/23/2016
	NAME:	GORDON GERALD 11265 W RUDDY DRIVE MARANA AZ 85653 US	
	CARD NO:	XXXXXXXXXXXX3235	AUTH CODE: 102541
	NAME ON CARD:	GORDON GERALD	
	EXPIRES:	04/2020	
	SIGNATURE:		

REMARKS

This receipt was generated by the automated BLM Collections and Billing System and is a paper representation of a portion of the official electronic record contained therein.

Run Date: 08/25/16

Run Time: 05:50 AM

**DEPARTMENT OF THE INTERIOR
BUREAU OF LAND MANAGEMENT
MINING CLAIMS**

MC Maintenance Fees Paid Through the BLM Pay Portal

CBS Receipt: 3624865

Printed For Lead File # **AMC437117**

Agency Tracking ID: 1470755693

Assessment Year: 2017

Number of BLM Serial Nr: 1

Paid On: 08/09/2016

Total Amount Paid: \$155.00

Claim Name	BLM Serial No	Lead File No	Amount Paid
BURIED TREASURE	AMC437118	AMC437117	\$155.00

**United States Department of the Interior
Bureau of Land Management
BUSINESS & SUPPORT SVCS DIV
ONE N CENTRAL AVE SUITE 800
PHOENIX, AZ 85004 -4427
Phone: (602) 417-9200**

Receipt

No: 3624865

Transaction #: 3728614	
Date of Transaction: 08/09/2016	
CUSTOMER:	
KENNETH WAGNER 8460 W REDROCK KIRKLAND, AZ 86332 US	

LINE #	QTY	DESCRIPTION	REMARKS	UNIT PRICE	TOTAL
1	1.00	LOCATABLE MINERALS / MINING CLAIMS- NOT NEW-UNADJUD, ONE AUTH NO. ONLY / MINING CLAIM MONEY RECEIVED CASES: AMC437118/\$155.00		- n/a -	155.00
TOTAL:					\$155.00

PAYMENT INFORMATION			
NOTE: Items will appear on credit card statement as "BLM O Mining Claim".			
1	AMOUNT:	155.00	POSTMARKED: N/A
	TYPE:	CREDIT CARD	RECEIVED: 08/09/2016
	NAME:	KENNETH WAGNER 8460 W REDROCK KIRKLAND AZ 86332 US	
	CARD NO:	XXXXXXXXXXXX3890	AUTH CODE: 09564A
	NAME ON CARD:	KENNETH WAGNER	
	EXPIRES:	03/2019	
	SIGNATURE:		

REMARKS

This receipt was generated by the automated BLM Collections and Billing System and is a paper representation of a portion of the official electronic record contained therein.

Run Date: 08/25/16

Run Time: 05:50 AM

**DEPARTMENT OF THE INTERIOR
BUREAU OF LAND MANAGEMENT
MINING CLAIMS**

MC Maintenance Fees Paid Through the BLM Pay Portal

CBS Receipt: 3624866

Printed For Lead File # **AMC437117**

Agency Tracking ID: 1470757050

Assessment Year: 2017

Number of BLM Serial Nr: 1

Paid On: 08/09/2016

Total Amount Paid: \$155.00

Claim Name	BLM Serial No	Lead File No	Amount Paid
GOLD PATCH	AMC437121	AMC437117	\$155.00

United States Department of the Interior
Bureau of Land Management
 BUSINESS & SUPPORT SVCS DIV
 ONE N CENTRAL AVE SUITE 800
 PHOENIX, AZ 85004 -4427
 Phone: (602) 417-9200

Receipt

No: 3624866

Transaction #: 3728615	
Date of Transaction: 08/09/2016	
CUSTOMER:	
KENNETH WAGNER 8460 W REDROCK KIRKLAND, AZ 86332 US	

LINE #	QTY	DESCRIPTION	REMARKS	UNIT PRICE	TOTAL
1	1.00	LOCATABLE MINERALS / MINING CLAIMS- NOT NEW-UNADJUD, ONE AUTH NO. ONLY / MINING CLAIM MONEY RECEIVED CASES: AMC437121/\$155.00		- n/a -	155.00
TOTAL:					\$155.00

PAYMENT INFORMATION					
NOTE: Items will appear on credit card statement as "BLM O Mining Claim".					
1	AMOUNT:	155.00	POSTMARKED:	N/A	
	TYPE:	CREDIT CARD	RECEIVED:	08/09/2016	
	NAME:	KENNETH WAGNER 8460 W REDROCK KIRKLAND AZ 86332 US			
	CARD NO:	XXXXXXXXXXXX3890	AUTH CODE:	05715A	
	NAME ON CARD:	KENNETH WAGNER			
	EXPIRES:	03/2019			
	SIGNATURE:				

REMARKS

This receipt was generated by the automated BLM Collections and Billing System and is a paper representation of a portion of the official electronic record contained therein.

UNITED STATES
DEPARTMENT OF THE INTERIOR
BUREAU OF LAND MANAGEMENT

437117

CREDIT CARD PAYMENT
For Mining Claim Maintenance Fee

THIS IS A CHANGE OF ADDRESS

TELEPHONE SUBMISSION - ACCURACY OF THE BELOW INFORMATION IS THE RESPONSIBILITY OF THE CLAIMANT/OWNER

NAME Michael R. BACHYNSKI
ADDRESS 7808 W PALMAIRE AVE
CITY Glendale STATE AZ ZIP 85303
PHONE # 623 - 552 1553

SEND RECEIPT TO Above address
 Other (Include Name and Mailing Address):

AMC NUMBER
437124

CLAIM/SITE NAME
Yellow Rock

1 # of Claim/Site
x 155.00 Each
\$ 155 Total Charged ERG (INITIALS)

RECEIPT # 3637053

DATE STAMP

RECEIVED
BLM AZ STATE OFFICE
2016 AUG 22 A 10:55
PHOENIX, ARIZONA

***** FOR OFFICIAL USE ONLY *****

DATE _____ INITIALS _____ VERIFIED _____

United States Department of the Interior
Bureau of Land Management
 DIV OF LANDS, MINRLS & ENERGY
 ONE N CENTRAL AVE
 PHOENIX, AZ 85004 -4427
 Phone: 602-417-9200

Receipt

No: 3637053

Transaction #: 3740899	
Date of Transaction: 08/22/2016	
CUSTOMER:	
MICHAEL BACHYNSKI 7808 W PALMAIRE AVE GLENDALE,AZ 85303-2429 US	

LINE #	QTY	DESCRIPTION	REMARKS	UNIT PRICE	TOTAL
1	1.00	LOCATABLE MINERALS / MINING CLAIMS- NOT NEW-UNADJUD,ONE AUTH NO. ONLY / MINING CLAIM MONEY RECEIVED CASES: AMC437124/\$155.00	2017 MAINT (1)	- n/a -	155.00
TOTAL:					\$155.00

PAYMENT INFORMATION			
NOTE: Items will appear on credit card statement as "Bureau of Land Mgmt CO".			
1	AMOUNT:	155.00	POSTMARKED: N/A
	TYPE:	CREDIT CARD	RECEIVED: 08/22/2016
	NAME:	BACHYNSKI, MICHAEL 7808 W PALMAIRE AVE GLENDALE AZ 85303-2429 US	
	CARD NO:	XXXXXXXXXXXX0312	AUTH CODE: 07078C
	NAME ON CARD:	MICHAEL R BACHYNSKI	
	EXPIRES:	04/2018	
	SIGNATURE:		

REMARKS

This receipt was generated by the automated BLM Collections and Billing System and is a paper representation of a portion of the official electronic record contained therein.

ENTERED
AUG 24 2016
 BY: 

NOTICE!!

These documents have been scanned!

Do not place un-scanned documents beneath this notice!

Do not remove this notice from this file!

GPO Jacket No. 560-102
Print Order 61540
Rise Business Services, LLC
Job=AZ15 5/2/2019



Box Number= AZ15019



Claim Begin-End: AMC437117-AMC437124

5 Miscellaneous



AZ15019-25

AMC436731-AMC437154

8/21/2016

AMC 437117
AMC 432478

Change of address update for Mining Claims

New address

Kenneth G Wagner
8460 W. Redrock
Kirkland, AZ 86332

Old address

Kenneth G Wagner
P.O. Box 154
414 Lincoln Ave
Delmar, IA 52037-0154

RECEIVED
BLM AZ STATE OFFICE
2016 AUG 24 P 1:34
PHOENIX, ARIZONA

If you have any questions please give me
a call Thank you Ken Wagner

563-593-5250

~~Kenneth Wagner~~ 8/21/2016

AMC 437121 Gold Patch ✓
AMC 437118 Buried Treasure ✓
AMC 432478 Hill Gold*

Address Updated*
ENTERED AUG 24 2016

PB

K. Wagner
8460 W. Redrock
Kirkland, AZ 86332

RECEIVED
BLM AZ STATE OFFICE

2016 AUG 24 P 1:34

PHOENIX, ARIZONA

PHOENIX, AZ 852

22 AUG 2016 PM 9 L



BLM Arizona state office
One North Central Ave.
Suite 800
Phoenix, AZ 85004-4427

85004-442700

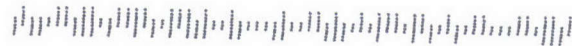

8/21/2016

AMC 437117
AMC 432478

Change of address update for Mining Claims

New address

Kenneth G Wagner
8460 W. Redrock
Kirkland, AZ 86332

Old address

Kenneth G Wagner
P.O. Box 154
414 Lincoln Ave
Delmar, IA 52037-0154

RECEIVED
BLM AZ STATE OFFICE
2016 AUG 24 P 1:34
PHOENIX, ARIZONA

If you have any questions please give me
a call Thank you Ken Wagner
563-593-5250
~~Kenneth G Wagner~~ 8/21/2016

AMC 437121 Gold Patch ✓
AMC 437118 Buried Treasure ✓
AMC 432478 Hill Gold *

Address Updated*
ENTERED AUG 24 2016
PB

K. Wagner
8460 W. Redrock
Kirkland, AZ 86332

RECEIVED
BLM AZ STATE OFFICE
2016 AUG 24 P 1:34
PHOENIX, ARIZONA

BLM Arizona state office
One North Central Ave.
Suite 800
Phoenix, AZ 85004-4427

PHOENIX AZ 852

22 AUG 2016 PM 9 L



85004-442700

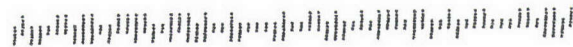

List of Proprietors

WAGNER KENNETH G[2402825], 8460 W RED ROCK RD, , KIRKLAND, AZ, 863326114, P, NOMATCH

Select

Cancel

[Sign In or Register](#)

[Live Chat](#)

[Home](#) > [Lookups](#) > [House Number by ZIP Code](#)

House or Building Number	Enter ZIP Code
<input type="text" value="8460"/>	<input type="text" value="86332"/>
<input type="button" value="Search"/>	<input type="button" value="Clear"/>

House Number by ZIP Code

- Display all the addresses with a given house number in a ZIP Code
- Information on the address: street name and ZIP+4
- Link to online map & aerial view
- Link to Property information page
- **Listware for Excel & Online** verifies, corrects & enhances the names, addresses, phones & emails. Up to 1,000 free Credits every month. [Learn More](#).

3 Addresses with House Number 8460 in Kirkland, AZ 86332

[Buy a list of all the Addresses in ZIP Code 86332](#)

[Buy a list of all the Businesses in ZIP Code 86332](#)

Address	ZIP+4	Map & Aerial View	Property
8460 S Mayo Dr	86332-4018	Map	Owner
8460 W Red Rock Rd	86332-6114	Map	Owner
8460 S Walden Blvd	86332-5102	Map	Owner

[How Can We Improve?](#) | [Trademarks](#) | [Privacy](#) | [Newsletter](#) | [Terms of Use](#) | [Result Codes](#) | [Map of Users](#)

Customer Name Update Screen

System ID: MC

Name:

Proprietor #: Renumber To:

Category:

Address:

City:

State:

Zip:
 UNDELIVERABLE

Email:

Phone:

ph # + EMAIL Address PB
ENTERED AUG 25 2016
8:46a (8/25/16) Mr. Wagner called, stated the address he submitted is correct even though it is not recognized by the database. I obtained his EMAIL address (if all else fails). PB

Customer details successfully saved for Customer Id 2402825

When Recorded Return Document to:

Gerald Gordon
1984 W. State Rd 10
Lake Village, IN, 46349

RECEIVED
BLM AZ STATE OFFICE

2016 SEP 22 P 2:55

PHOENIX, ARIZONA

STATEMENT OF AGREEMENT

I Gerald Gordon of 1984 W. State Rd 10, Lake Village, IN, 46349
PRINT FIRST and LAST NAME PRINT CURRENT ADDRESS

Owner of AMC437119 (Cui~~az~~), AMC437121 (Gold Patch), AMC437122 (Gold Peak), and AMC437123 (Lucky Lady), do hereby agree to follow and comply with the stipulations set forth by the DEPARTMENT OF THE INTERIOR, Bureau of Land Management, Arizona and described within:

Gila and Salt River Meridian, Yavapai County, Arizona

T. 8 N., R. 5 W.,

sec. 14.

Order Opening Public Lands to Mineral Location, Entry, and Patent – dated November 12, 1954.

The Order is attached and made part of this agreement.

Dated this 19 day of September, 2016.

By [Signature]

STATE OF IN
County of NEWTON



DONNA K CORNING
NOTARY PUBLIC - NEWTON COUNTY
MY COMMISSION EXPIRES JULY 28 2024

This instrument was acknowledged and executed before me, this 19 day of September, 2016 by Gerald Gordon, he/she acknowledged that he/she executed the same for the purpose set forth herein.

My commission expires: July 28, 2024

[Signature]
Notary Public

Gerald Gordon
1984 W. State Rd 10
Lake Village, IN, 46349



Bureau of Land Management
One North Central Ave
Suite 800, Attn: ReAnn Myers
Phoenix, AZ, 85004-4427

PHOENIX, ARIZONA

2016 SEP 22 P 2:56

RECEIVED
BLM AZ STATE OFFICE

8500434427 0041



NOTICE!!

These documents have been scanned!

Do not place un-scanned documents beneath this notice!

Do not remove this notice from this file!

GPO Jacket No. 560-102
Print Order 61540
Rise Business Services, LLC
Job=AZ15 5/2/2019



Box Number= AZ15019



Claim Begin-End: AMC437117-AMC437124

6 Location Notices-Amendments and Supporting Documents



AZ15019-25

AMC436731-AMC437154

Mining Claim Status Report

Data Entered: 03/16/16 RAM

MTP Checked By: YML
GEO Checked By: YML

LEAD SERIAL NUMBER: AMC 437117 thru AMC 437124

NUMBER OF CLAIMS & TYPE:

8 LODE
8 PLACER
ASSOCIATION PLACER
MILL SITE
TUNNEL SITE

CHARGES:

Location Fee @ \$37 = \$ 296
Processing Fee @ \$20 = \$ 160
Maintenance Fee @ \$155 = \$ 1,240
Add'l Maint Fee for Assoc Placer = \$
SUBTOTAL \$
Other Fees \$
Other Fees \$
TOTAL \$ 1,696

TOTAL ACREAGE: 20 Per Claim
(Placer Only)

NUMBER OF LOCATORS: 1

DOCUMENTS RECEIVED VIA: Over-the-Counter Mail TIMELY FILED: Yes No

LEGAL DESCRIPTION: T 10N R 5W SEC 27, 28
T 8N R 5W SEC 11, 15
T _____ R _____ SEC _____
T _____ R _____ SEC _____
T _____ R _____ SEC _____

BLM FOREST SERVICE SUBJ TO PL 359: Yes No
WILDERNESS AREA

SPLIT ESTATE: N/A SX PX OTHER
SRHA Was proper Notice filed if located on SHRA Land? Yes No

RECONVEYED MINERALS ON BLM LAND REQUIRE OPENING ORDER FROM 1944 TO 1993:
Open to Entry On _____ N/A

COMMENTS/STATUS: VOID PARTIALLY VOID PVT MINERALS WITHDRAWN LANDS
OTHER AMC 437119, 437121, 437122 SUBJ TO STIP.

Claimant acknowledges that portions of the following claim(s) site(s) may be void or voidable.

Printed Name of Claimant _____ Signature of Claimant _____

*****FINAL ADJUDICATION*****

DATE 7/27/2016 INITIALS RAM

AMC 437117

GERALD GORDON
P.O. Box 800
Congress, AZ, 85332

LOCATION NOTICE FOR PLACER MINING CLAIM

Amendment BLM Serial # _____

NOTICE IS HEREBY GIVEN that the BOULDER MOVE
_____ placer mining claim has been located by
GERALD GORDON whose current mailing
address is P.O. Box 800, Congress, AZ, 85332

RECEIVED
BLM AZ STATE OFFICE
2016 MAR 14 A 10:41
PHOENIX, ARIZONA
BLM
Date
Stamp

The general course of this claim is E-W RECTANGLE and it is situated in Yavapai
County, Arizona. This claim is 1320 feet in length and 660 feet in width.

20 Total Claim Acreage. This claim runs from the location monument on which this location notice is
posted at the SE corner of the claim approximately 1320 feet in a WEST direction to the
WEST end line and 660 feet in a NORTH direction to the NORTH end line. This claim is
marked by four monuments, one at each corner of the claim.

The location monument on which this notice is posted is situated within Section 27, Township
10 N, Range 5 W, Gila Salt River Base and Meridian, Arizona. This claim encompasses
portions of the following legal subdivision(s) if located by legal subdivision or the following quarter section(s),
section(s), Township(s) and Range(s) S1/2 SW1/4 NW1/4 SEC.27 T10N R5W
_____, Gila Salt River Base and Meridian, Arizona.

The locality of this claim with reference to some natural object or permanent monument and additional information
(if any) concerning its locality are as follows: THE SW CORNER OF THE CLAIM IS LOCATED
2640' NORTH 0' EAST OF THE USGLO SURVEY PIN STAMPED "S27 S28 S33
S34 1916" The above information is shown on the attached map.

DATED AND POSTED on the ground this 10 day of MARCH, 20 16.

LOCATOR(s) AGENT

Print Name(s) GERALD GORDON

Signature(s) *Gerald Gordon*

Form MCF102
Revised July 2014

AN0437117

MINING CLAIM MAP

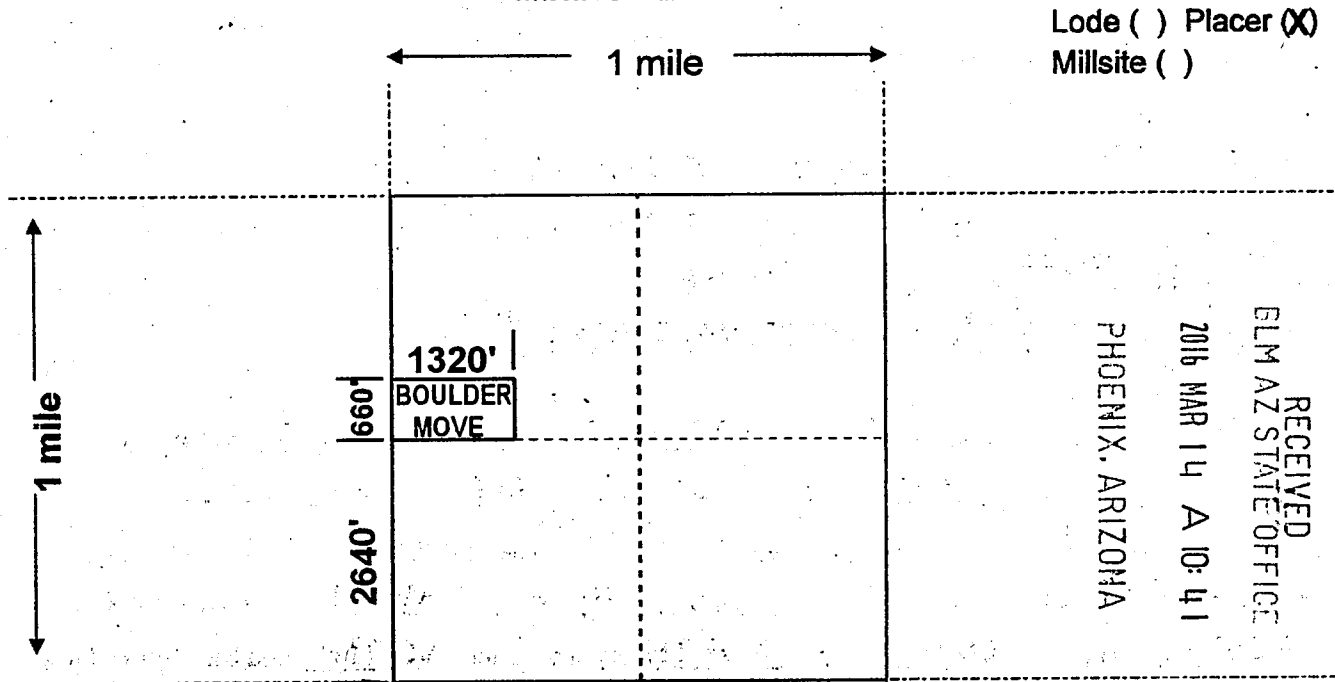

USGLO SURV PIN S27S28S33S34 1916
all corners are 90 degrees unless specified.

Scale: 1" = 2000 feet



- The above map depicts the BOULDER MOVE mining claim, which is located in Section (s) 27, Township 10 N, Range 5 W, Gila and Salt River Base and Meridian, YAVAPAI County, Arizona. Total claim acreage is 20
- The type of corner and location monuments used are as follows: 2"X5' Tall PVC pipe with aluminum name tag.
- The bearings and distances in degrees and feet between claim corners and to a public land survey monument are as depicted on the map.
- If the claim is a placer or millsite claim with exterior limits conforming to legal subdivisions of the public survey, provide a legal description of the claim S1/2 SW1/4 NW1/4 SEC.27 T10N R5W, GSRB&M, AZ

Form MCF100a
Revised July 2014

This form is available from the Arizona Geology Survey and may be reproduced.

AMC4371171

GERALD GORDON
P.O. Box 800
Congress, AZ, 85332

LOCATION NOTICE FOR PLACER MINING CLAIM

Amendment BLM Serial # _____

NOTICE IS HEREBY GIVEN that the **BURIED TREASURE**

_____ placer mining claim has been located by

GERALD GORDON whose current mailing

address is **P.O. Box 800, Congress, AZ, 85332**

BLM
Date
Stamp

RECEIVED
BLM AZ STATE OFFICE
2016 MAR 14 A 10:41
PHOENIX, ARIZONA

The general course of this claim is **N-S RECTANGLE** and it is situated in **Yavapai**
County, Arizona. This claim is **1320** feet in length and **660** feet in width.

20 Total Claim Acreage. This claim runs from the location monument on which this location notice is posted at the **SE** corner of the claim approximately **1320** feet in a **NORTH** direction to the **NORTH** end line and **660** feet in a **WEST** direction to the **WEST** end line. This claim is marked by four monuments, one at each corner of the claim.

The location monument on which this notice is posted is situated within Section **27**, Township **10 N**, Range **5 W**, Gila Salt River Base and Meridian, Arizona. This claim encompasses portions of the following legal subdivision(s) if located by legal subdivision or the following quarter section(s), section(s), Township(s) and Range(s) **E1/2NW1/4SW1/4 SEC 27 T10N R5W**

_____, Gila Salt River Base and Meridian, Arizona.

The locality of this claim with reference to some natural object or permanent monument and additional information (if any) concerning its locality are as follows: **The SE corner of the claim is 1320' East and 1320' North of the USGLO Surv Pin Stamped S27, S28, S33, S34 1916**

_____ The above information is shown on the attached map.

DATED AND POSTED on the ground this **26** day of **FEBRUARY**, 20 **16**.

LOCATOR(s) AGENT

Print Name(s) **GERALD GORDON**

Signature(s) *Gerald Gordon*

Form MCF102
Revised July 2014

AMC437118

MINING CLAIM MAP

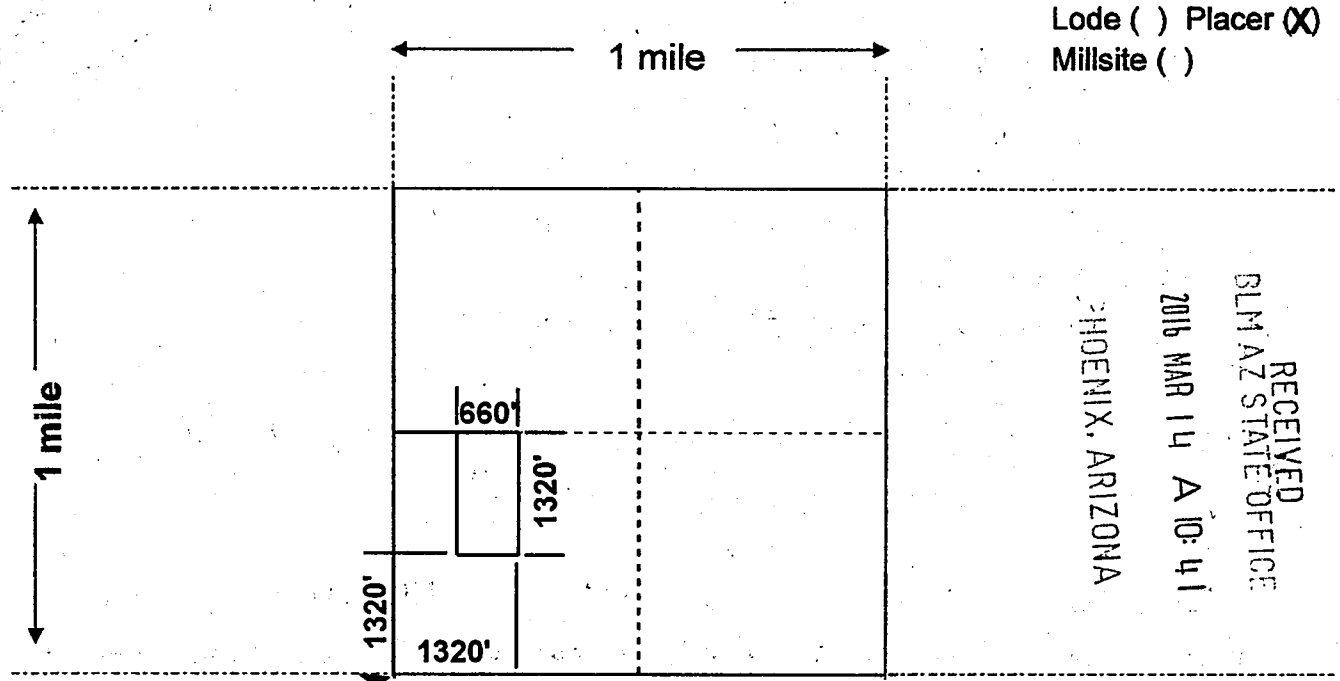

USGLO Surv pin stamped S27, S28, S33, S34 1916
 all corners are 90 degrees unless specified.

Scale: 1" = 2000 feet



1. The above map depicts the Buried Treasure mining claim, which is located in Section (s) 27, Township 10 N, Range 5 W, Gila and Salt River Base and Meridian, YAVAPAI County, Arizona. Total claim acreage is 20
2. The type of corner and location monuments used are as follows: 2"X5' Tall PVC pipe with aluminum name tag.
3. The bearings and distances in degrees and feet between claim corners and to a public land survey monument are as depicted on the map.
4. If the claim is a placer or millsite claim with exterior limits conforming to legal subdivisions of the public survey, provide a legal description of the claim E1/2NW1/4SW1/4 SEC 27 T10N R5W, GSRB&M, AZ

Form MCF100a
 Revised July 2014

This form is available from the Arizona Geology Survey and may be reproduced.

AMC437118

GERALD GORDON
P.O. Box 800
Congress, AZ, 85332

LOCATION NOTICE FOR PLACER MINING CLAIM

Amendment BLM Serial # _____

NOTICE IS HEREBY GIVEN that the CUINAZ
_____ placer mining claim has been located by
GERALD GORDON whose current mailing
address is P.O. Box 800, Congress, AZ, 85332

BLM
Date
Stamp

RECEIVED
BLM AZ STATE OFFICE
2016 MAR 14 A 10:41
PHOENIX, ARIZONA

The general course of this claim is W-E RECTANGLE and it is situated in Yavapai
County, Arizona. This claim is 1320 feet in length and 660 feet in width.

20 Total Claim Acreage. This claim runs from the location monument on which this location notice is
posted at the SW corner of the claim approximately 1320 feet in a EAST direction to the
EAST end line and 660 feet in a NORTH direction to the NORTH end line. This claim is
marked by four monuments, one at each corner of the claim.

The location monument on which this notice is posted is situated within Section 11, Township
8 N, Range 5 W, Gila Salt River Base and Meridian, Arizona. This claim encompasses
portions of the following legal subdivision(s) if located by legal subdivision or the following quarter section(s),
section(s), Township(s) and Range(s) S1/2NW1/4SW1/4 SEC.11T8NR5W
_____, Gila Salt River Base and Meridian, Arizona.

The locality of this claim with reference to some natural object or permanent monument and additional information
(if any) concerning its locality are as follows: THE SW CORNER IS 1320'N 0'E OF THE DOI
BLM SURVEY STAKE STAMPED "T8NR5W S10 S11 S15 S14 1970"

_____ The above information is shown on the attached map.

DATED AND POSTED on the ground this 9TH day of MARCH, 20 16.

LOCATOR(s) AGENT

Print Name(s) GERALD GORDON

Signature(s) *Gerald Gordon*

Form MCF102
Revised July 2014

AMC4371191

MINING CLAIM MAP

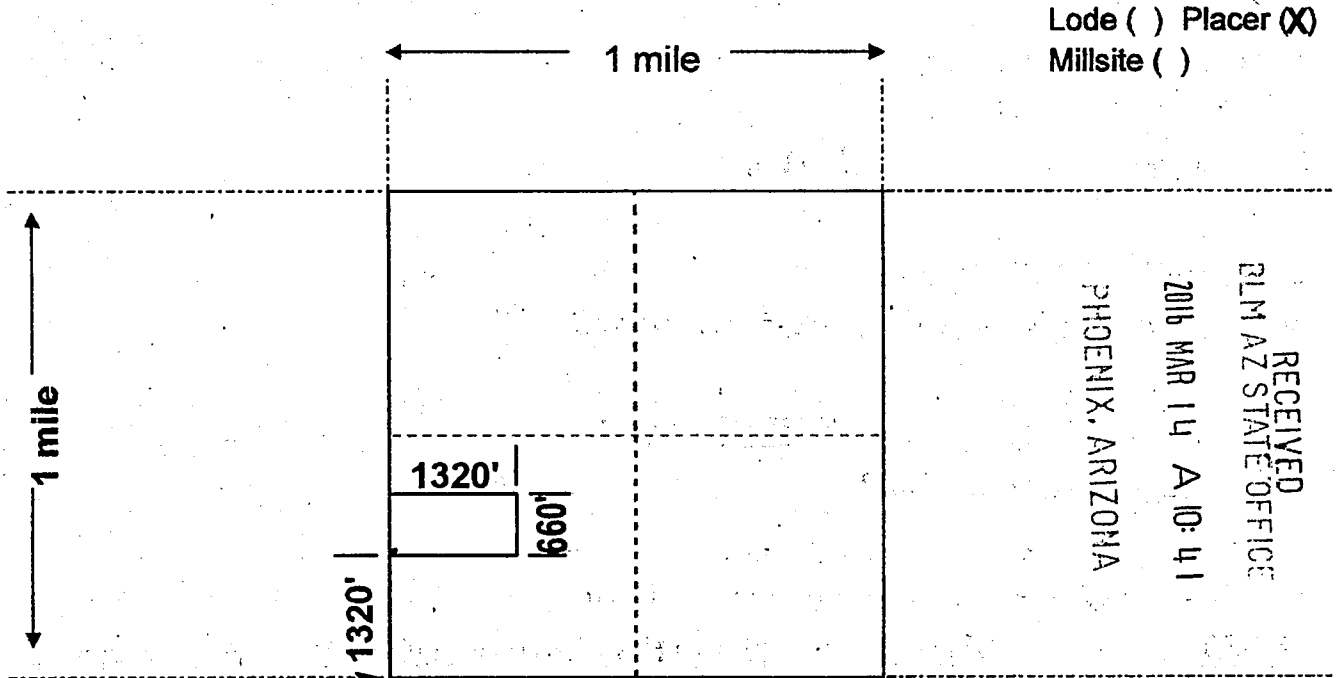

US DOI-BLM SURVEY STAKE STAMPED "T8NR5W S10S11S15S14 1970"
all corners are 90 degrees unless specified.



Scale: 1" = 2000 feet

1. The above map depicts the CUINAZ mining claim, which is located in Section (s) 11, Township 8 N, Range 5 W, Gila and Salt River Base and Meridian, YAVAPAI County, Arizona. Total claim acreage is 20
2. The type of corner and location monuments used are as follows: 2"X5' Tall PVC pipe with aluminum name tag.
3. The bearings and distances in degrees and feet between claim corners and to a public land survey monument are as depicted on the map.
4. If the claim is a placer or millsite claim with exterior limits conforming to legal subdivisions of the public survey, provide a legal description of the claim S1/2NW1/4SW1/4 SEC.11 T8NR5W GSRB&M, AZ

AMC437119

Form MCF100a
Revised July 2014

GERALD GORDON
P.O. Box 800
Congress, AZ, 85332

LOCATION NOTICE FOR PLACER MINING CLAIM

Amendment BLM Serial # _____

NOTICE IS HEREBY GIVEN that the DIG IT
_____ placer mining claim has been located by
GERALD GORDON whose current mailing
address is P.O. Box 800, Congress, AZ, 85332

BLM
Date
Stamp

RECEIVED
BLM AZ STATE OFFICE
2016 MAR 14 A 10:41
PHOENIX, ARIZONA

The general course of this claim is N-S RECTANGLE and it is situated in Yavapai
County, Arizona. This claim is 1320 feet in length and 660 feet in width.

20 Total Claim Acreage. This claim runs from the location monument on which this location notice is
posted at the SW corner of the claim approximately 1320 feet in a NORTH direction to the
NORTH end line and 660 feet in a EAST direction to the EAST end line. This claim is
marked by four monuments, one at each corner of the claim.

The location monument on which this notice is posted is situated within Section 28, Township
10 N, Range 5 W, Gila Salt River Base and Meridian, Arizona. This claim encompasses
portions of the following legal subdivision(s) if located by legal subdivision or the following quarter section(s),
section(s), Township(s) and Range(s) E1/2 SW1/4 SE1/4 SEC.28 T10N R5W
_____, Gila Salt River Base and Meridian, Arizona.

The locality of this claim with reference to some natural object or permanent monument and additional information
(if any) concerning its locality are as follows: THE NE CORNER OF THE CLAIM IS LOCATED
AT THE DOI SURVEY PIN STAMPED "SE1/16 T10NR5W 1988

_____ The above information is shown on the attached map.

DATED AND POSTED on the ground this 10 day of MARCH, 20 16.

LOCATOR(s) AGENT

Print Name(s) GERALD GORDON

Signature(s) _____

Form MCF102
Revised July 2014

AMC437120

MINING CLAIM MAP

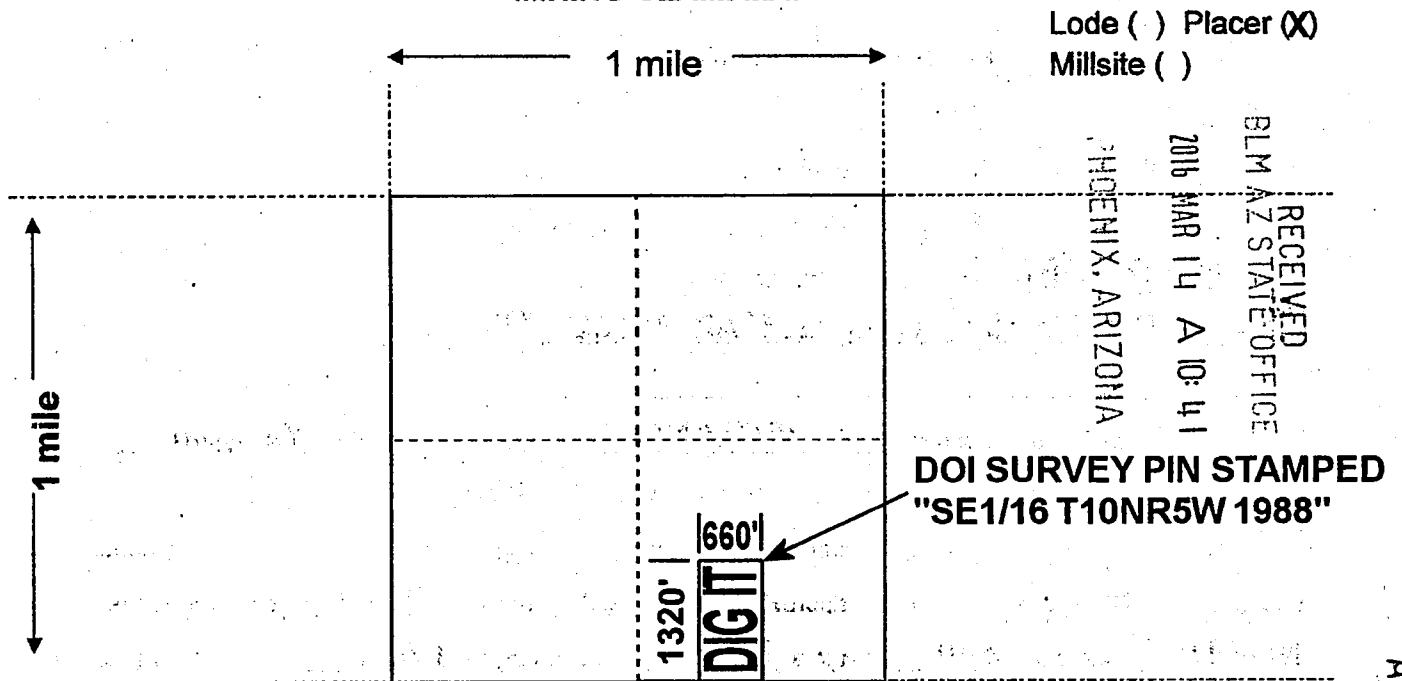

all corners are 90 degrees unless specified.

Scale: 1" = 2000 feet



1. The above map depicts the DIG IT mining claim, which is located in Section (s) 28, Township 10 N, Range 5 W, Gila and Salt River Base and Meridian, YAVAPAI County, Arizona. Total claim acreage is 20
2. The type of corner and location monuments used are as follows: 2"X5' Tall PVC pipe with aluminum name tag.
3. The bearings and distances in degrees and feet between claim corners and to a public land survey monument are as depicted on the map.
4. If the claim is a placer or millsite claim with exterior limits conforming to legal subdivisions of the public survey, provide a legal description of the claim E1/2SW1/4SE1/4 SEC.28T10NR5W, GSRB&M, AZ

Form MCF100a
Revised July 2014

This form is available from the Arizona Geology Survey and may be reproduced.

AMC437120

GERALD GORDON
P.O. Box 800
Congress, AZ, 85332

LOCATION NOTICE FOR PLACER MINING CLAIM

Amendment BLM Serial # _____

NOTICE IS HEREBY GIVEN that the GOLD PATCH
_____ placer mining claim has been located by
GERALD GORDON whose current mailing
address is P.O. Box 800, Congress, AZ, 85332

RECEIVED
BLM AZ STATE OFFICE
2016 MAR 14 A 10:41
PHOENIX, ARIZONA
BLM
Date
Stamp

The general course of this claim is W-E RECTANGLE and it is situated in Yavapai
County, Arizona. This claim is 1320 feet in length and 660 feet in width.

20 Total Claim Acreage. This claim runs from the location monument on which this location notice is
posted at the NW corner of the claim approximately 1320 feet in a EAST direction to the
EAST end line and 660 feet in a SOUTH direction to the SOUTH end line. This claim is
marked by four monuments, one at each corner of the claim.

The location monument on which this notice is posted is situated within Section 11, Township
8 N, Range 5 W, Gila Salt River Base and Meridian, Arizona. This claim encompasses
portions of the following legal subdivision(s) if located by legal subdivision or the following quarter section(s),
section(s), Township(s) and Range(s) S1/2SW1/4SW1/4 SEC.11T8NR5W

_____, Gila Salt River Base and Meridian, Arizona.

The locality of this claim with reference to some natural object or permanent monument and additional information
(if any) concerning its locality are as follows: THE SW CORNER IS 0'N 0'E OF THE DOI
BLM SURVEY STAKE STAMPED "T8NR5W S10 S11 S15 S14 1970"

The above information is shown on the attached map.

DATED AND POSTED on the ground this 9TH day of MARCH, 20 16.

LOCATOR(s) AGENT

Print Name(s) GERALD GORDON

Signature(s) *Gerald Gordon*

Form MCF102
Revised July 2014

AMC437121

MINING CLAIM MAP

Lode () Placer (X)
Millsite ()

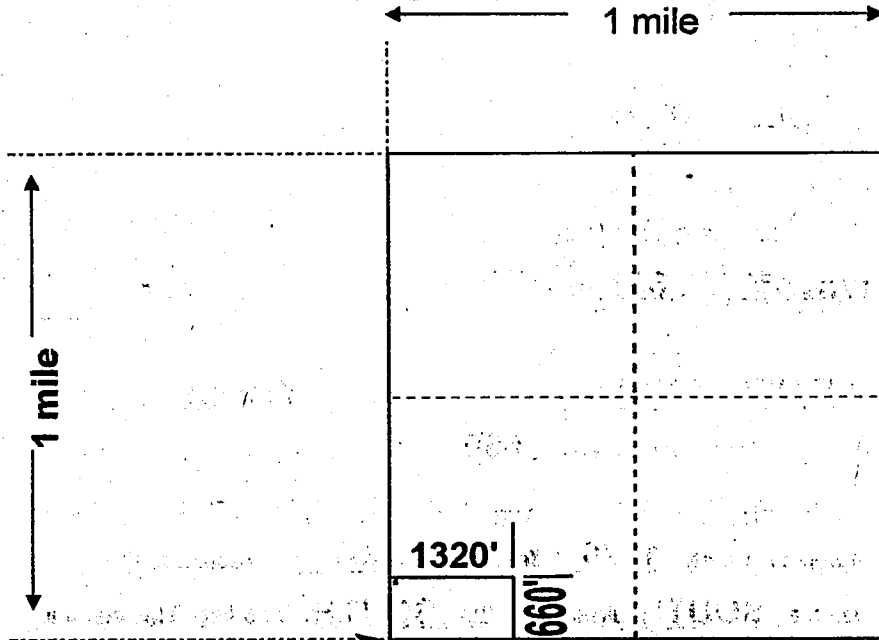

RECEIVED
BLM AZ STATE OFFICE
2016 MAR 14 A 10:41
PHOENIX, ARIZONA

US DOI-BLM SURVEY STAKE STAMPED "T8NR5W S10S11S15S14 1970"
all corners are 90 degrees unless specified.

Scale: 1" = 2000 feet



1. The above map depicts the GOLD PATCH mining claim, which is located in Section (s) 11, Township 8 N, Range 5 W, Gila and Salt River Base and Meridian, YAVAPAI County, Arizona. Total claim acreage is 20

2. The type of corner and location monuments used are as follows: 2"X5' Tall PVC pipe with aluminum name tag.

3. The bearings and distances in degrees and feet between claim corners and to a public land survey monument are as depicted on the map.

4. If the claim is a placer or millsite claim with exterior limits conforming to legal subdivisions of the public survey, provide a legal description of the claim S1/2SW1/4SW1/4SEC.11T8NR5W GSRB&M, AZ

Form MCF100a
Revised July 2014

This form is available from the Arizona Geology Survey and may be reproduced.

AMC4371211

GERALD GORDON
P.O. Box 800
Congress, AZ, 85332

LOCATION NOTICE FOR PLACER MINING CLAIM

Amendment BLM Serial # _____

NOTICE IS HEREBY GIVEN that the GOLD PEAK
_____ placer mining claim has been located by
GERALD GORDON whose current mailing
address is P.O. Box 800, Congress, AZ, 85332

BLM
Date
Stamp

RECEIVED
BLM AZ STATE OFFICE
2016 MAR 14 A 10:41
PHOENIX, ARIZONA

The general course of this claim is W-E RECTANGLE and it is situated in Yavapai
County, Arizona. This claim is 1320 feet in length and 660 feet in width.

20 Total Claim Acreage. This claim runs from the location monument on which this location notice is
posted at the NW corner of the claim approximately 1320 feet in a EAST direction to the
EAST end line and 660 feet in a SOUTH direction to the SOUTH end line. This claim is
marked by four monuments, one at each corner of the claim.

The location monument on which this notice is posted is situated within Section 11, Township
8 N, Range 5 W, Gila Salt River Base and Meridian, Arizona. This claim encompasses
portions of the following legal subdivision(s) if located by legal subdivision or the following quarter section(s),
section(s), Township(s) and Range(s) N1/2NW1/4SW1/4 SEC.11T8NR5W

_____, Gila Salt River Base and Meridian, Arizona.

The locality of this claim with reference to some natural object or permanent monument and additional information
(if any) concerning its locality are as follows: THE NW CORNER IS 2640'N 0'E OF THE DOI
BLM SURVEY STAKE STAMPED "T8NR5W S10 S11 S15 S14 1970"

The above information is shown on the attached map.

DATED AND POSTED on the ground this 9TH day of MARCH, 20 16.

LOCATOR(s) AGENT

Print Name(s) GERALD GORDON

Signature(s) _____

Form MCF102
Revised July 2014

AHC437122

MINING CLAIM MAP

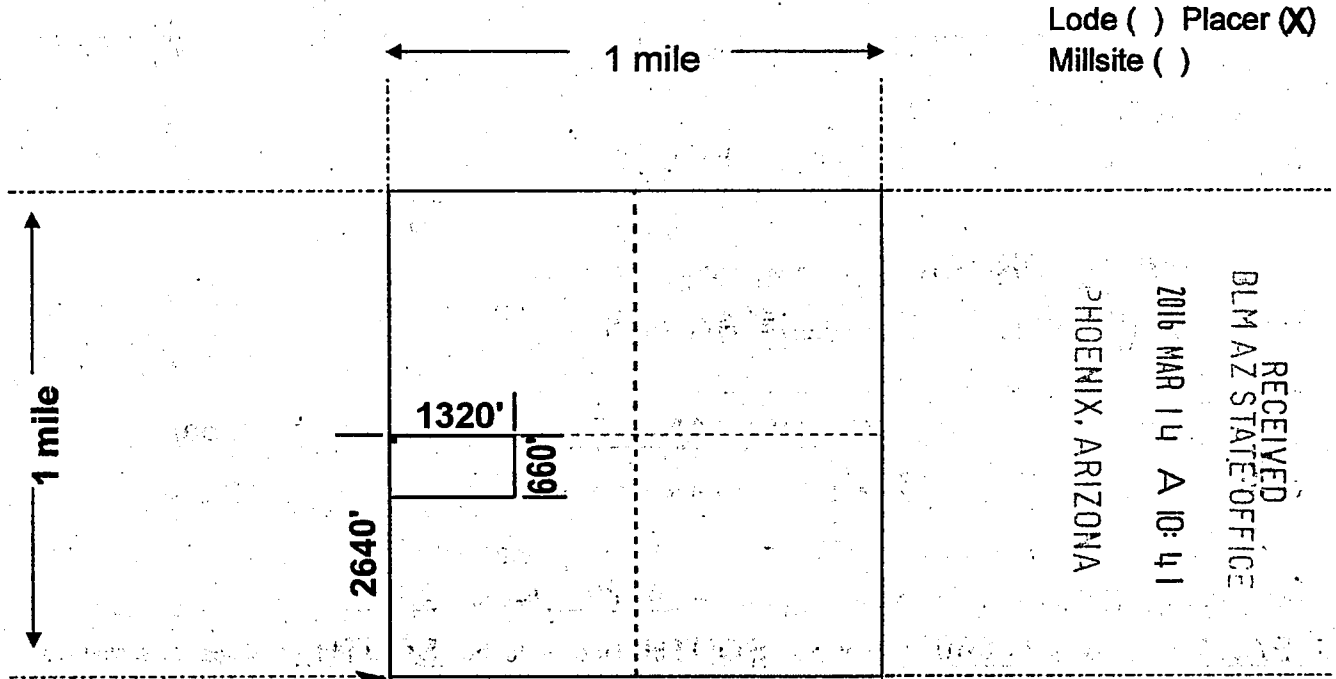

US DOI-BLM SURVEY STAKE STAMPED "T8NR5W S10S11S15S14 1970"
all corners are 90 degrees unless specified.



Scale: 1" = 2000 feet

1. The above map depicts the GOLD PEAK mining claim, which is located in Section (s) 11, Township 8 N, Range 5 W, Gila and Salt River Base and Meridian, YAVAPAI County, Arizona. Total claim acreage is 20
2. The type of corner and location monuments used are as follows: 2"X5' Tall PVC pipe with aluminum name tag.
3. The bearings and distances in degrees and feet between claim corners and to a public land survey monument are as depicted on the map.
4. If the claim is a placer or millsite claim with exterior limits conforming to legal subdivisions of the public survey, provide a legal description of the claim N1/2NW1/4SW1/4 SEC.11 T8NR5W GSRB&M, AZ

Form MCF100a
Revised July 2014

This form is available from the Arizona Geology Survey and may be reproduced.

AMC4371221

GERALD GORDON
P.O. Box 800
Congress, AZ, 85332

LOCATION NOTICE FOR PLACER MINING CLAIM

Amendment BLM Serial # _____

NOTICE IS HEREBY GIVEN that the LUCKY LADY
_____ placer mining claim has been located by
GERALD GORDON whose current mailing
address is P.O. Box 800, Congress, AZ, 85332

BLM
Date
Stamp

RECEIVED
BLM AZ STATE OFFICE
2016 MAR 14 A 10:41
PHOENIX, ARIZONA

The general course of this claim is W-E RECTANGLE and it is situated in Yavapai
County, Arizona. This claim is 1320 feet in length and 660 feet in width.

20 Total Claim Acreage. This claim runs from the location monument on which this location notice is
posted at the NW corner of the claim approximately 1320 feet in a EAST direction to the
EAST end line and 660 feet in a SOUTH direction to the SOUTH end line. This claim is
marked by four monuments, one at each corner of the claim.

The location monument on which this notice is posted is situated within Section 11, Township
8 N, Range 5 W, Gila Salt River Base and Meridian, Arizona. This claim encompasses
portions of the following legal subdivision(s) if located by legal subdivision or the following quarter section(s),
section(s), Township(s) and Range(s) N1/2SW1/4SW1/4 SEC.11T8NR5W
_____, Gila Salt River Base and Meridian, Arizona.

The locality of this claim with reference to some natural object or permanent monument and additional information
(if any) concerning its locality are as follows: THE NW CORNER IS 1320'N 0'E OF THE DOI
BLM SURVEY STAKE STAMPED "T8NR5W S10 S11 S15 S14 1970"

_____ The above information is shown on the attached map.

DATED AND POSTED on the ground this 9TH day of MARCH, 20 16.

LOCATOR(s) AGENT

Print Name(s) GERALD GORDON

Signature(s) _____

Form MCF102
Revised July 2014

AN C 4 3 7 1 2 3

MINING CLAIM MAP

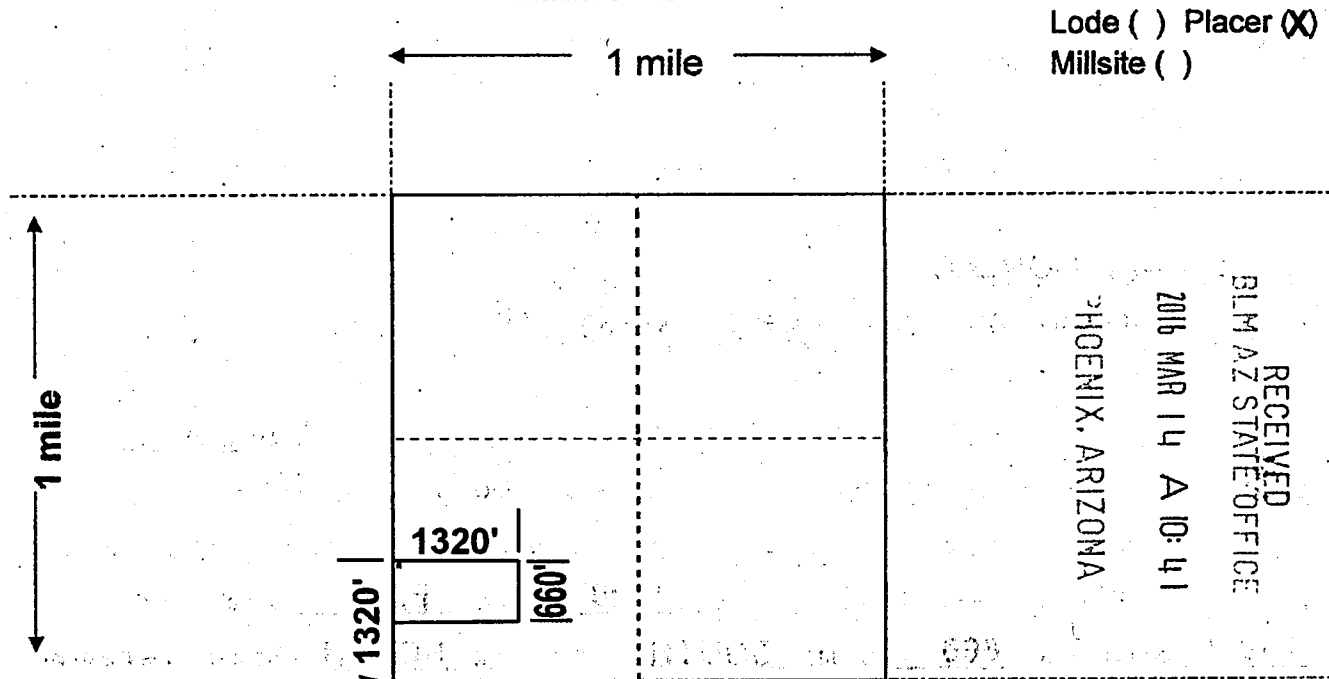

US DOI-BLM SURVEY STAKE STAMPED "T8NR5W S10S11S15S14 1970"
all corners are 90 degrees unless specified.



Scale: 1" = 2000 feet

- The above map depicts the LUCKY LADY mining claim, which is located in Section (s) 11, Township 8 N, Range 5 W, Gila and Salt River Base and Meridian, YAVAPAI County, Arizona. Total claim acreage is 20
- The type of corner and location monuments used are as follows: 2"X5' Tall PVC pipe with aluminum name tag.
- The bearings and distances in degrees and feet between claim corners and to a public land survey monument are as depicted on the map.
- If the claim is a placer or millsite claim with exterior limits conforming to legal subdivisions of the public survey, provide a legal description of the claim N1/2SW1/4SW1/4 T8NR5W GSRB&M, AZ

Form MCF100a
Revised July 2014

This form is available from the Arizona Geology Survey and may be reproduced.

AMC437123

GERALD GORDON
P.O. Box 800
Congress, AZ, 85332

LOCATION NOTICE FOR PLACER MINING CLAIM

Amendment BLM Serial # _____

NOTICE IS HEREBY GIVEN that the YELLOW ROCK
_____ placer mining claim has been located by
GERALD GORDON whose current mailing
address is P.O. Box 800, Congress, AZ, 85332

RECEIVED
BLM AZ STATE OFFICE
2016 MAR 14 A 10:4
PHOENIX, ARIZONA
BLM
Date
Stamp

The general course of this claim is W-E RECTANGLE and it is situated in Yavapai
County, Arizona. This claim is 1320 feet in length and 660 feet in width.

20 Total Claim Acreage. This claim runs from the location monument on which this location notice is
posted at the SE corner of the claim approximately 1320 feet in a WEST direction to the
WEST end line and 660 feet in a NORTH direction to the NORTH end line. This claim is
marked by four monuments, one at each corner of the claim.

The location monument on which this notice is posted is situated within Section 15, Township
8 N, Range 5 W, Gila Salt River Base and Meridian, Arizona. This claim encompasses
portions of the following legal subdivision(s) if located by legal subdivision or the following quarter section(s),
section(s), Township(s) and Range(s) N1/2NW1/4NE1/4 SEC.15T8NR5W
_____, Gila Salt River Base and Meridian, Arizona.

The locality of this claim with reference to some natural object or permanent monument and additional information
(if any) concerning its locality are as follows: THE NE CORNER IS 0'N 1320'W OF THE DOI
BLM SURVEY STAKE STAMPED "T8NR5W S10 S11 S15 S14 1970"

_____ The above information is shown on the attached map.

DATED AND POSTED on the ground this 8TH day of MARCH, 20 16.

LOCATOR(s) AGENT

Print Name(s) GERALD GORDON

Signature(s) *Gerald Gordon*

Form MCF102
Revised July 2014

AMC437124

MINING CLAIM MAP

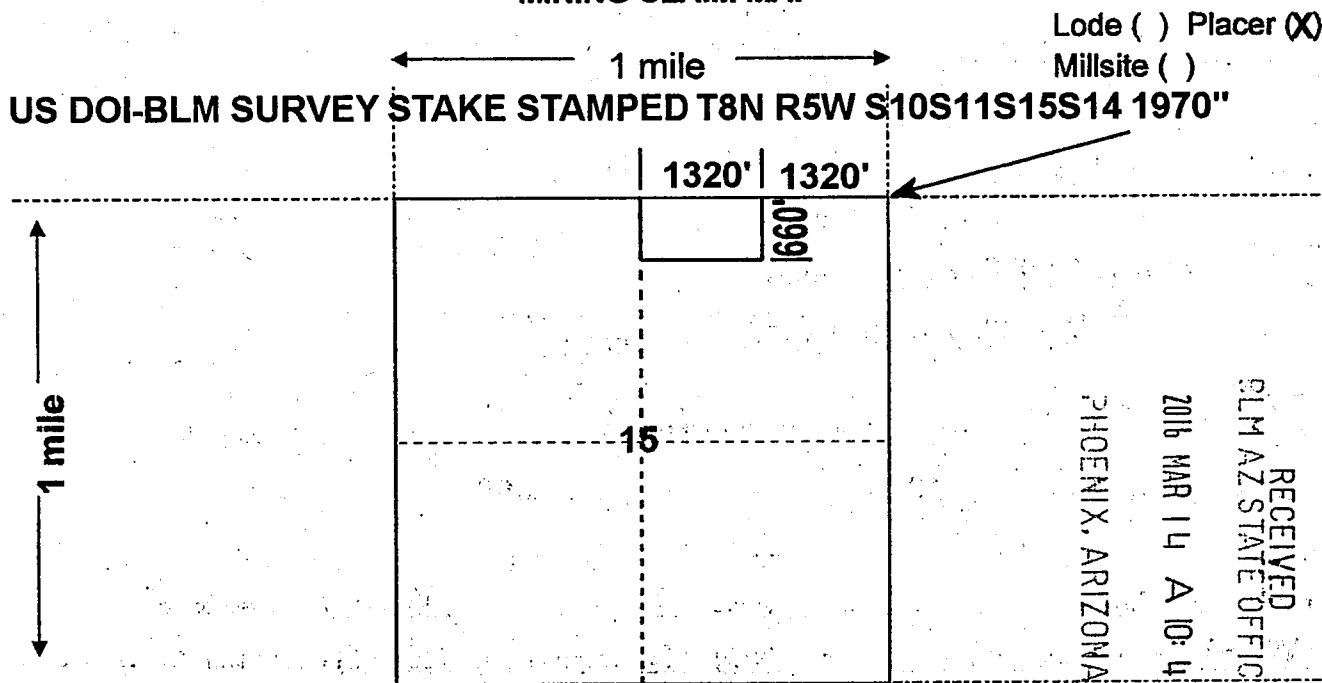

all corners are 90 degrees unless specified.



Scale: 1" = 2000 feet

1. The above map depicts the YELLOW ROCK mining claim, which is located in Section (s) 15, Township 8 N, Range 5 W, Gila and Salt River Base and Meridian, YAVAPAI County, Arizona. Total claim acreage is 20
2. The type of corner and location monuments used are as follows: 2"X5' Tall PVC pipe with aluminum name tag.
3. The bearings and distances in degrees and feet between claim corners and to a public land survey monument are as depicted on the map.
4. If the claim is a placer or millsite claim with exterior limits conforming to legal subdivisions of the public survey, provide a legal description of the claim N1/2NW1/4NE1/4 SEC.15 T8N R5W GSRB&M, AZ

Form MCF100a
Revised July 2014

This form is available from the Arizona Geology Survey and may be reproduced.

AMC437124

RECEIVED
BLM AZ STATE OFFICE
2016 MAR 14 A 10:41
PHOENIX, ARIZONA

Input Parameters for Geographic Report with Land

System Id = CR

Admin State = AZ

Geo State =

Casetype Begins With

Case Disp Txt = AUTHORIZED, CANCELLED, EXPIRED, PENDING, REJECTED, RELINQUISHED, VOID, WITHDRAWN

Mer Twp Rng =

Section =

Mtrs = 14 0080N 0050W 011, 14 0080N 0050W 015, 14 0080N 0050W 999, 14 0100N 0050W 027, 14 0100N 0050W 028, 14 0100N 0050W 999

Commodity =

Commodity Txt =

Pending Org =

Pend Org Decode =

Total Rows Returned: 13

RUN TIME: 10:39 AM

UNITED STATES DEPARTMENT OF INTERIOR
BUREAU OF LAND MANAGEMENT
GEOGRAPHIC REPORT WITH LAND
Sorted by Serial Number

RUN DATE: 03/14/2016

Page 1 of 3

Adm State: AZ

Serial Number: AZA 018699

Total Case Acres: 0.500

<u>Casetype</u>	<u>Case Disp</u>	14	0080N	0050W	<u>Sect</u>	<u>Sur Typ</u>	<u>Sur Num</u>	<u>Suff</u>	<u>Subdivision</u>	<u>Act Pend</u>
281007	AUTHORIZED				015	FF		1	EAST 33' OF N2SWNW;	

Serial Number: AZA 023556

Total Case Acres: 29.900

<u>Casetype</u>	<u>Case Disp</u>	14	0100N	0050W	<u>Sect</u>	<u>Sur Typ</u>	<u>Sur Num</u>	<u>Suff</u>	<u>Subdivision</u>	<u>Act Pend</u>
281001	AUTHORIZED				028	ALIQ MNR MNR		1	SESW; E2SWSW; W2SWSW;	

Serial Number: AZA 023855

Total Case Acres: 10.000

<u>Casetype</u>	<u>Case Disp</u>	14	0080N	0050W	<u>Sect</u>	<u>Sur Typ</u>	<u>Sur Num</u>	<u>Suff</u>	<u>Subdivision</u>	<u>Act Pend</u>
271000	AUTHORIZED				015	MNR		1	NENENW;	

Serial Number: AZA 023858

Total Case Acres: 40.000

<u>Casetype</u>	<u>Case Disp</u>	14	0080N	0050W	<u>Sect</u>	<u>Sur Typ</u>	<u>Sur Num</u>	<u>Suff</u>	<u>Subdivision</u>	<u>Act Pend</u>
272000	AUTHORIZED				015	ALIQ			NWNW;	

Serial Number: AZA 024422

Total Case Acres: 4.130

<u>Casetype</u>	<u>Case Disp</u>	14	0100N	0050W	<u>Sect</u>	<u>Sur Typ</u>	<u>Sur Num</u>	<u>Suff</u>	<u>Subdivision</u>	<u>Act Pend</u>
287001	AUTHORIZED				028	ALIQ			S2S2;	

RUN TIME: 10:39 AM

UNITED STATES DEPARTMENT OF INTERIOR
BUREAU OF LAND MANAGEMENT
GEOGRAPHIC REPORT WITH LAND
Sorted by Serial Number

RUN DATE: 03/14/2016
Page 2 of 3

Adm State: AZ

Serial Number: AZA 024551
Total Case Acres: 1.000

<u>Casetype</u>	<u>Case Disp</u>				<u>Sect</u>	<u>Sur Typ</u>	<u>Sur Num</u>	<u>Suff</u>	<u>Subdivision</u>	<u>Act Pend</u>
292803	PENDING	14	0080N	0050W	011	ALIQ			SE;	Y

Serial Number: AZA 031469
Total Case Acres: 9.930

<u>Casetype</u>	<u>Case Disp</u>				<u>Sect</u>	<u>Sur Typ</u>	<u>Sur Num</u>	<u>Suff</u>	<u>Subdivision</u>	<u>Act Pend</u>
281001	AUTHORIZED	14	0080N	0050W	011 015	ALIQ ALIQ			SW; NWNE,E2NW,NWSW;	

Serial Number: AZA 031568
Total Case Acres: 1.000

<u>Casetype</u>	<u>Case Disp</u>				<u>Sect</u>	<u>Sur Typ</u>	<u>Sur Num</u>	<u>Suff</u>	<u>Subdivision</u>	<u>Act Pend</u>
293200	EXPIRED	14	0080N	0050W	011	FF			PORTION OF;	

Serial Number: AZA 032543
Total Case Acres: 0.190

<u>Casetype</u>	<u>Case Disp</u>				<u>Sect</u>	<u>Sur Typ</u>	<u>Sur Num</u>	<u>Suff</u>	<u>Subdivision</u>	<u>Act Pend</u>
281001	AUTHORIZED	14	0080N	0050W	015	MNR			N2NWSW;	

Serial Number: AZA 035151
Total Case Acres: 1.000

<u>Casetype</u>	<u>Case Disp</u>				<u>Sect</u>	<u>Sur Typ</u>	<u>Sur Num</u>	<u>Suff</u>	<u>Subdivision</u>	<u>Act Pend</u>
293200	PENDING	14	0080N	0050W	011	FF			PORTION OF;	

RUN TIME: 10:39 AM

UNITED STATES DEPARTMENT OF INTERIOR
BUREAU OF LAND MANAGEMENT
GEOGRAPHIC REPORT WITH LAND
Sorted by Serial Number

RUN DATE: 03/14/2016
Page 3 of 3

Adm State: AZ

Serial Number: AZAR 0000110
Total Case Acres: 39.400

<u>Casetype</u>	<u>Case Disp</u>				<u>Sect</u>	<u>Sur Typ</u>	<u>Sur Num</u>	<u>Suff</u>	<u>Subdivision</u>	<u>Act Pend</u>
285003	AUTHORIZED	14	0080N	0050W	015	ALIQ			E2;	

TOWNSHIP 8 NORTH RANGE 5 WEST OF THE GILA AND SALT RIVER MERIDIAN, ARIZONA

YAVAPAI/MARICOPA COUNTY

STATUS OF PUBLIC DOMAIN
LAND AND MINERAL TITLES

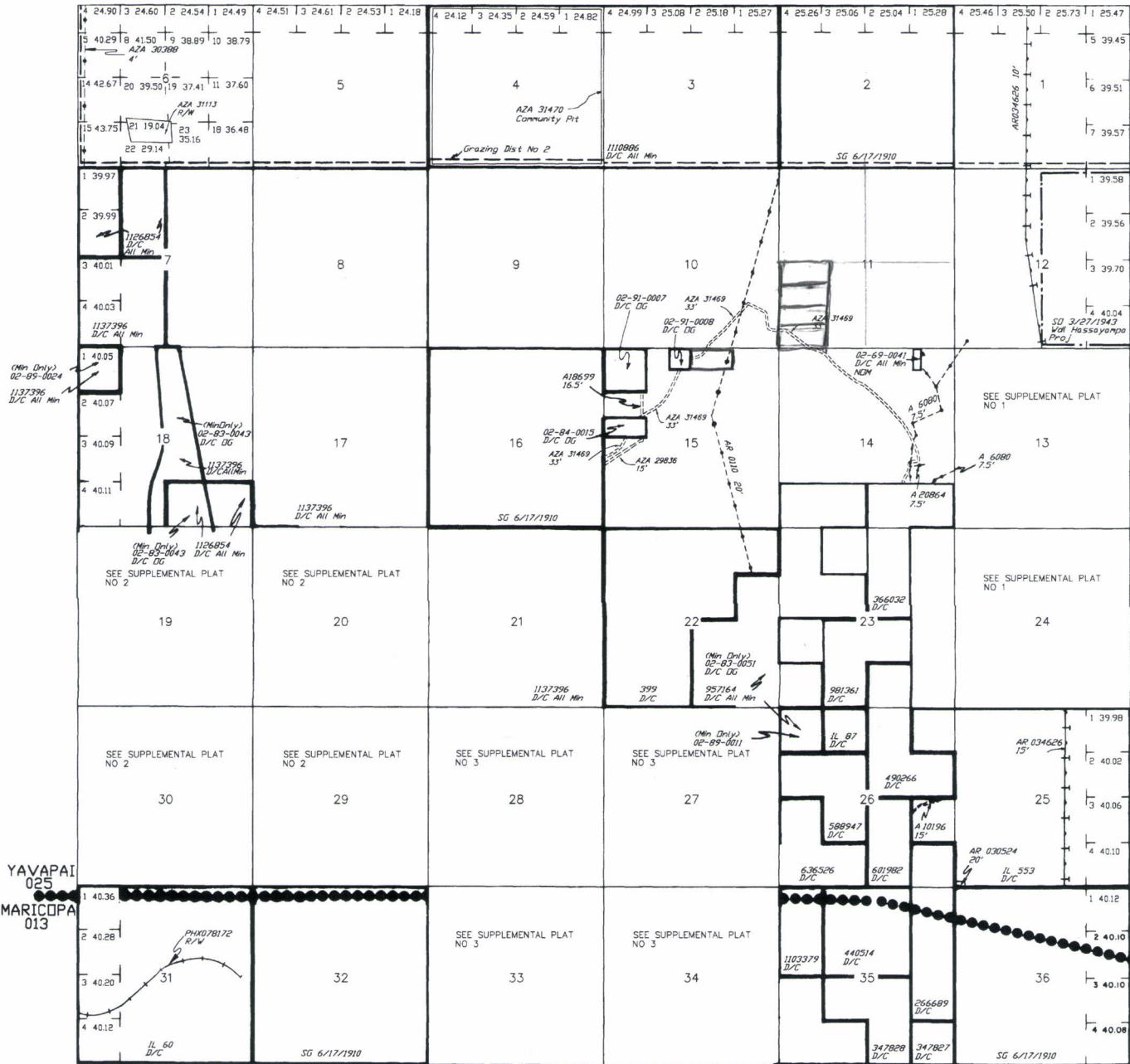

RESURVEY TRACT NO	T	R	SEC	SUBDIVISION

FOR ORDERS AFFECTING DISPOSAL OR USE OF UNIDENTIFIED LANDS WITHDRAWN FOR CLASSIFICATION, MINERALS, WATER AND/OR OTHER PUBLIC PURPOSES, REFER TO INDEX OF MISCELLANEOUS DOCUMENTS.

DIST NO 2
MDS 300 NE
A 18698 R/W (Access Rds)
Sec 15 : SW1/4NW1/4, SE1/4NW1/4, NE1/4NW1/4
Rec'd Stips
PHX 086852, A 20886, PHX 086854, AR036159, AR 036160, AR 036161, A 2995, A 2890 - A 2889, A 3184, A 7803, A 7815, A 8912

0 11/12/1954 Opens to ME Subj to Stips
Sec 11 : NE1/4, W1/2, NW1/4SE1/4
Secs 12, 13 : All
Sec 14 : NE1/4NE1/4, S1/2NE1/4, NW1/4NW1/4, NE1/4SW1/4, N1/2SE1/4

0 11/21/1958 Opens to ME Subj to Stips
Sec 1 : Lots 1-7, SW1/4NE1/4, S1/2NW1/4, SW1/4

Rec'd Stips
AMC 60947-60950, AMC 95964, AMC 127001-AMC 127005, AMC 127015-AMC 127020, AMC 127039-AMC 127044, AMC 127064-AMC 127065, AMC 127153, AMC 134573, AMC 261687-AMC 261690, AMC 281212, AMC 281213, AMC 281215, AMC 28126, AMC 283486, AMC 283487, AMC 283489, AMC 303939

AZA 30702 R/W
Sec 23 : NE1/4NE1/4

AZA 30703 R/W
Sec 23 : NE1/4NE1/4

AZA 30616 R/W
Sec 23 : NE1/4NE1/4

Lot 33°59'08"N
Long 112°43'29"W

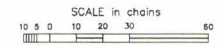

WARNING STATEMENT
This plot is the Bureau's Record of Title, and should be used only as a graphic display of the township survey data. Records hereon do not reflect title changes which may have been effected by lateral movements of rivers or other bodies of water. Refer to the cadastral surveys for official survey information.

CURRENT TO	BT	T	8 N
4-23-2003	PV	R	5 W

TOWNSHIP 10 NORTH RANGE 5 WEST OF THE GILA AND SALT RIVER MERIDIAN, ARIZONA

YAVAPAI COUNTY
MASSA YAMPA FIELD OFFICE

T 11N
R 5W R 4W

STATUS OF PUBLIC DOMAIN
LAND AND MINERAL TITLES

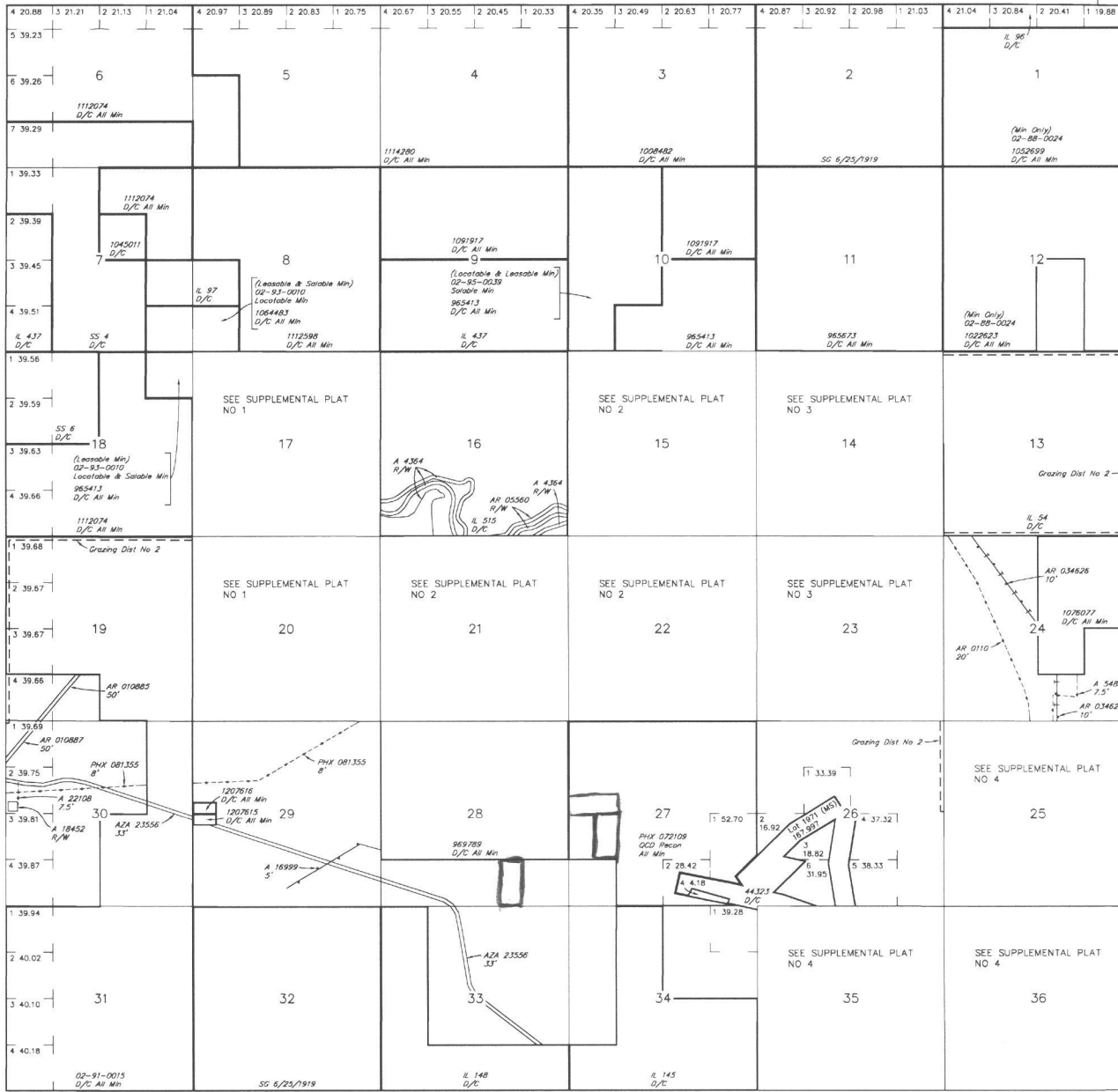

INDEX TO SEGREGATED TRACTS					
RESURVEY		ORIGINAL SURVEY			
TRACT NO	T	R	SEC	SUBDIVISION	

FOR ORDERS AFFECTING DISPOSAL OR USE OF UNIDENTIFIED LANDS WITHDRAWN FOR CLASSIFICATION, MINERALS, WATER AND/OR OTHER PUBLIC PURPOSES, REFER TO INDEX OF MISCELLANEOUS DOCUMENTS.

- MDS 301 NE
- 302 SW
- 303 SE
- A 15999 R/W Telephone & Telegraph 5'
- Sec 14: Lot 3
- Sec 21: Lot B, 1, 3, 14
- AZA 24422 Water Facility B'
- Sec 28: S1/2S1/2
- Sec 29: S1/2
- AZA 36146 R/W Road 5'
- Sec 14: Lot 1, 2, 4
- Sec 23: Lot 1, 2, N1/2NW1/4

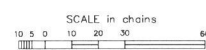

WARNING STATEMENT
This plot is the Bureau's Record of Title, and should be used only as a graphic display of the township survey data. Records herein do not reflect title changes which may have been affected by lateral movements of rivers or other bodies of water. Refer to the cadastral surveys for official survey information.

CURRENT TO	NW	GSR Mer
10-19-2015	ACAD	T 10 N
		R 5 W

Lot 34°09'29.40"N
Long 112°43'06.46"W

under the public-land laws filed on or before 10:00 a. m. of the 101st day after the date of this order shall be treated as though simultaneously filed at that time.

Inquiries concerning these lands shall be addressed to Manager, Arizona Land Office, Bureau of Land Management, Room 243 Main Post Office Building, Phoenix, Arizona.

E. I. ROWLAND,
State Supervisor.

[F. R. Doc. 54-9072; Filed, Nov. 17, 1954;
8:47 a. m.]

[Doc. 14]

ARIZONA

RESTORATION TO MINERAL LOCATION, ENTRY AND PATENT OF LANDS WITHDRAWN FOR RECLAMATION PURPOSES

NOVEMBER 12, 1954.

Pursuant to determinations by the Bureau of Reclamation under the act of April 23, 1932 (47 Stat. 136; 43 U. S. C. 154) and in accordance with the authority delegated to me by the Director, Bureau of Land Management, in Order No. 541, dated April 21, 1954 (19 F. R. 2473) it is ordered as follows:

Subject to valid existing rights, the provisions of existing withdrawals, and the stipulations and provisions described below, the lands hereinafter described, so far as they are withdrawn or reserved for reclamation purposes, are hereby restored to location, entry and patent under the mining laws.

GILA AND SALT RIVER MERIDIAN

- T. 8 N., R. 5 W.,
- Sec. 11, N $\frac{1}{2}$, SW $\frac{1}{4}$, NW $\frac{1}{4}$ SE $\frac{1}{4}$,
- Sec. 12, All;
- Sec. 13, All;
- Sec. 14, E $\frac{1}{2}$ NE $\frac{1}{4}$, SW $\frac{1}{4}$ NE $\frac{1}{4}$, NW $\frac{1}{4}$ NW $\frac{1}{4}$, NE $\frac{1}{4}$ SW $\frac{1}{4}$, N $\frac{1}{2}$ SE $\frac{1}{4}$.

Within the above described areas are 2,007.34 acres of public land.

Subject to valid existing rights and the provisions of existing withdrawals, the described lands shall, commencing at 10:00 a. m. on the 10th day after the date of this order, be open to location, entry and patenting under the United States mining laws, subject to the stipulation quoted below, to be executed and acknowledged in favor of the United States by the locators for themselves, their heirs, successors and assigns, and recorded in the county records and in the United States Land Office at Phoenix, Arizona, before locations are made:

In carrying on the mining and milling operations contemplated hereunder, locator will, by means of substantial dikes, or other adequate structures, confine all tailings, debris and harmful chemicals in such a manner that the same shall not be carried into the Hassayampa River by storm waters, or otherwise.

There is reserved to the United States, its agents and employees, at all times, free ingress to, passage over and egress from all of the above described lands for the purpose of inspection; there is further reserved to the United States, its successors and assigns the prior right to use any of the lands hereinabove described, to construct, operate, and maintain canals, dikes, wasteways, ditches,

dams, reservoirs, telephone and telegraph lines, electric transmission lines, roadways and appurtenant works, including the right to take and remove from the lands hereinabove described such construction materials as may be required in the construction of irrigation works, without any payment made by the United States, or its successor for such rights. The locator further agrees that the United States, its officers, agents and employees and its successors and assigns, shall not be held liable for any damage to the improvements or workings of the locator resulting from the construction, operation and maintenance of any works of the United States and/or the removal of construction materials from the lands hereinabove described.

Inquiries concerning these lands shall be addressed to Manager, Arizona Land Office, Bureau of Land Management, Room 243 Main Post Office Building, Phoenix, Arizona.

E. I. ROWLAND,
State Supervisor.

[F. R. Doc. 54-9071; Filed, Nov. 17, 1954;
8:47 a. m.]

NORTH DAKOTA

NOTICE OF PROPOSED WITHDRAWAL AND RESERVATION OF LANDS

NOVEMBER 12, 1954.

An application, serial number Montana 013419, (ND) for the withdrawal from all forms of appropriation under the public land laws, including mining and mineral leasing laws of the lands described below was filed on July 7, 1953, by Department of the Army.

The purposes of the proposed withdrawal: For the operation and maintenance of the Garrison Dam and Reservoir Project, North Dakota.

For a period of thirty days from the date of publication of this notice, persons having cause to object to the proposed withdrawal may present their objections in writing to the State Supervisor, Bureau of Land Management, Department of the Interior at Billings, Montana. In case any objection is filed and the nature of the opposition is such as to warrant it, a public hearing will be held at a convenient time and place, which will be announced, where opponents to the order may state their views and where proponents of the order can explain its purpose.

The determination of the Secretary on the application will be published in the FEDERAL REGISTER, either in the form of a public land order or in the form of a notice of determination if the application is rejected. In either case, a separate notice will be sent to each interested party of record.

The lands involved in the application are:

FIFTH PRINCIPAL MERIDIAN

- T. 148 N., R. 82 W.,
- Sec. 29: SE $\frac{1}{4}$ SW $\frac{1}{4}$,
- Sec. 32: Lot 1.
- T. 148 N., R. 83 W.,
- Sec. 13: NE $\frac{1}{4}$ SE $\frac{1}{4}$.
- T. 148 N., R. 84 W.,
- Sec. 6: Lot 12.
- T. 147 N., R. 84 W.,
- Sec. 10: Lot 5.
- T. 148 N., R. 85 W.,
- Sec. 30: Lot 3.

- T. 147 N., R. 83 W.,
- Sec. 34: Lots 1, 2, 3, 4 and unsurveyed accretions thereto.
- T. 153 N., R. 83 W.,
- Sec. 6: Unsurveyed accretion in front of Lots 7, 8;
- Sec. 7: Unsurveyed accretion in front of Lots 1, 2, 3;
- Sec. 8: Lots 2, 4 and unsurveyed accretion thereto;
- Sec. 17: Unsurveyed accretion in front of Lot 7;
- Sec. 19: Unsurveyed accretion in front of Lots 3, 4, 7;
- Sec. 20: Unsurveyed accretion in front of Lots 1, 2, Lots 3, 4, 5;
- Sec. 23: Lots 1, 2, 3, E $\frac{1}{2}$ NW $\frac{1}{4}$, SE $\frac{1}{4}$ SE $\frac{1}{4}$, NW $\frac{1}{4}$ SE $\frac{1}{4}$.
- Sec. 27: Unsurveyed accretion in front of Lot 7;
- Sec. 29: Unsurveyed accretion in front of Lots 4, 5;
- Sec. 34: Unsurveyed accretion in front of Lot 1;
- Sec. 35: Lots 1, 2, E $\frac{1}{2}$ NE $\frac{1}{4}$, Unsurveyed accretion in front of Lots 4, 5.
- T. 147 N., R. 84 W.,
- Sec. 20: Lot 4;
- Sec. 28: Lot 1.
- T. 153 N., R. 84 W.,
- Sec. 1: Unsurveyed accretion in front of Lot 7;
- Sec. 2: Lot 3;
- Sec. 3: Lots 1, 2, 4;
- Secs. 2, 3, 4, 8, 10: Unsurveyed portions, consisting of island in Missouri River.
- T. 154 N., R. 84 W.,
- Sec. 23: NE $\frac{1}{4}$ SE $\frac{1}{4}$,
- Sec. 28: Unsurveyed accretion in front of Lots 1, 2, 3, 4;
- Sec. 29: Unsurveyed accretion in front of Lots 1, 2, 3, 4, 5;
- Sec. 30: Unsurveyed accretion in front of Lot 3;
- Sec. 33: Unsurveyed accretion in front of Lots 2, 3;
- Sec. 34: Lots 1, 2;
- Sec. 35: Lot 2;
- Secs. 27, 33, 34, 35: Unsurveyed portions, consisting of island in Missouri River.
- T. 148 N., R. 85 W.,
- Sec. 31: Lots 2, 4, 5 and unsurveyed accretions thereto;
- Sec. 34: SE $\frac{1}{4}$ SW $\frac{1}{4}$.
- T. 154 N., R. 85 W.,
- Sec. 17: NE $\frac{1}{4}$ SE $\frac{1}{4}$;
- Sec. 21: NE $\frac{1}{4}$ NW $\frac{1}{4}$;
- Sec. 25: Unsurveyed accretion in front of Lots 1, 2, 3, 4;
- Sec. 29: Unsurveyed accretion in front of Lots 5, 6, 7;
- Sec. 27: Unsurveyed accretion in front of Lots 4, 5, 6;
- Sec. 28: Unsurveyed accretion in front of Lots 1, 2;
- Sec. 29: Lot 1 and unsurveyed accretion thereto; Lot 2, E $\frac{1}{2}$ SW $\frac{1}{4}$, SW $\frac{1}{4}$ SW $\frac{1}{4}$;
- Sec. 30: Lots 3, 4, 5, NE $\frac{1}{4}$ SE $\frac{1}{4}$,
- Sec. 31: Lot 1;
- Sec. 32: Lots 3, 4.
- T. 154 N., R. 86 W.,
- Secs. 25 and 26: Unsurveyed island in Missouri River;
- Sec. 27: Lot 4;
- Sec. 30: Unsurveyed accretion in front of Lots 3, 4.
- T. 154 N., R. 87 W.,
- Sec. 21: Unsurveyed accretion in front of Lots 1, 2, 3;
- Sec. 23: Unsurveyed accretion in front of Lots 2, 3; Lots 4, 5, 6, 7, SW $\frac{1}{4}$ SE $\frac{1}{4}$,
- Sec. 23: Lots 2, 7 and unsurveyed accretions thereto; Lots 3, 5;
- Sec. 27: Lot 1;
- Sec. 28: Unsurveyed accretions in front of Lots 1, 7; Lots 4, 5, 6 and unsurveyed accretion thereto;
- Sec. 29: Unsurveyed accretion in front of Lots 5, 6, 7, 8;
- Sec. 30: Unsurveyed accretion in front of Lots 7, 8.

TOWNSHIP 08 NORTH RANGE 05 WEST OF THE GILA & SALT RIVER MERIDIAN, ARIZONA

SECS	SUBDIVISION																Acres	Kind of Entry or Purpose	Serial Number or Order Number	Action Date	Remarks		
	NE 1/4				NW 1/4				SW 1/4				SE 1/4									Lots	Other Description
	NE	NW	SW	SE	NE	NW	SW	SE	NE	NW	SW	SE	NE	NW	SW	SE							
For orders affecting disposal or use of unidentified lands withdrawn for classification, minerals, water, and/or other public purposes, and Indian treaties, refer to Index to Miscellaneous Documents																							
13					X	X	X	X	X	X	X	X					3	8N 4W;	279.51	O REST PWR SITE RESERVE 188, SO 6/16/1911	AR-13	11/12/1954	OPEN TO ENTRY;
11	X	X	X	X	X	X	X	X	X	X	X	X	X										
12																		ALL;					
13																		ALL;					
14	X	X	X	X	X				X				X	X					2007.34	O OPENING TO ME	AR-14	11/12/1954	SUBJ TO STIPULATIONS;
1			X			X	X	X	X	X	X	X	X	X			1-7	7N 4W;		O OPENING TO ME	AR-195	11/21/1958	SUBJ TO STIPULATIONS;
25											X									AR-030524	8/22/1961	PREPERMIT; APPVD 9/14/1961; TO TERM 9/13/2011;	
9																		NWSENE;	10.00	SLUP ELECTRONIC TESTING AREA	AR-031175	2/9/1962	EXPIRED 2/8/1964;
22	X	X	X		X	X	X	X	X	X	X	X											
27	X	X	X	X	X	X	X	X											680.00	O CL / PS BLM MOTION	AR-021633	12/27/1962	CANC;
23																		W2SENE, E2SENE, E2NE, W2NE, W2N, W2NW, E2SW, W2SW, W2S, W2SE, W2E, W2NE, W2N, W2NW, W2S, W2SE, W2E, W2NE;		MINING CLAIM LOCATION - PL 359	AR-034576	1/21/1965	MILLSITES; CLOSED 9/28/1973;
1						X	X		X								3						
12				X		X	X		X						X								
13	X	X		X													3,4						
24		X											X	X			2						
25	X	X											X	X						RAW TELEPHONE AND TELEGRAPH LINE	AR-034626	11/10/1965	TO TERM 10/28/2015; OTHER TPS: 9N 5W, 10N 5W, 12 1/2N 3W;
9																		A STRIP OF LAND 50 FT WIDE;	6.555	SLUP	A-43	8/17/1966	TO EXPIRE 8/16/1971; EXT; EXPIRED 6/16/1976;
3																		ALL;					
10																		ALL;					
11																		ALL;					
15																		ALL;					
22																		ALL;		O CANC WDL PWR PROJECT AR-774, O 12/31/1935	A-795	3/17/1967	FPC; 13N 2W;
24	X	X	X	X	X	X			X	X			X	X	X	X	1N 4W;			O PROPOSED CL FOR MULTIPLE USE MANAGEMENT	A-1100	7/21/1967	SEGREGATES THE PUBLIC LANDS FROM APPROPRIATION UNDER AGRICULTURAL LAND LAWS, PS, SX; PUB IN FR 7/27/1967; O CL 10/17/1967; PUB IN FR 10/23/1967; CL TERM 10/7/1981;
22	X	X	X		X	X	X	X	X	X	X	X					6N 4W;	440.00	IL		399	10/2/1967	
27	X	X	X	X	X	X	X	X									13N 27E;	240.00	IL		421	3/12/1968	
12																	M&B;		MINING CLAIM LOCATION - PL 359	AR-036159	10/8/1968	FILED 12/10/1956;	
12																	M&B;		MINING CLAIM LOCATION - PL 359	AR-036160	10/8/1968	FILED 12/10/1956;	